

# Come on down!

**You're the Next Contestant on...**



**\* First Ever Licensed Pusher  
Built & Priced in the **

**\* Skill Slide Coin Entry**

**\* 1 Year Warranty  
on Pusher Motor &  
Main Board**



**Ticket "Drawer" Makes  
Loading Tickets & Other  
Operator Adjustments Easy!**

Dimensions: 31" d x 41" w x 87" h  
Weight: 500 lbs.

THE PRICE IS RIGHT is a trademark of FremantleMedia Operations BV. © 2008 FremantleMedia North America, Inc. All Rights Reserved. Based on the FremantleMedia television program 'The Price is Right'. Licensed by FremantleMedia Enterprises [www.fremantlemedia.com](http://www.fremantlemedia.com).

**Innovative Concepts in Entertainment • 10123 Main Street • Clarence, New York 14031  
Phone: 716-759-0370 Fax: 716-759-0390 • Email: [play@icegame.com](mailto:play@icegame.com) • Visit: [www.icegame.com](http://www.icegame.com)**



# TABLE OF CONTENTS

<b>Safety and Warnings</b>	3
<b>Setup</b>	
Game Play Feature	4
Meters	5
Programming	5 & 6
Errors	6
Playfield	7
<b>Trouble Shooting</b>	
Security Slam Switches	8
Power supply	9
<b>Assembly Diagrams</b>	
Cabinet PE1000X	10 - 11
Big Bonus Wheel PE3110X	12 - 14
Skill Coin Chute PE1006X	15 - 16
Ticket Drawer PE3011X	17 - 18
Programming Console PE3011X	19
Coin Drawer PE1009X	20
Playfield Deck PE3130	21-23
Deck PE3076	24 - 25
Cabinet Layout PE1100X	26
Marquee PE3127X	27
<b>Spares</b>	28
<b>Wiring Diagrams</b>	29 - 49
<b>Main Logic Board Connector Layout</b>	50
<b>Warranty</b>	51 - 52

# SAFETY AND WARNINGS

## BEFORE YOU BEGIN

WARNING: WHEN INSTALLING THIS GAME, A GROUNDED A.C. RECEPTACLE MUST BE USED. FAILURE TO DO SO COULD RESULT IN INJURY TO YOURSELF OR OTHERS. FAILURE TO USE A GROUNDED RECEPTACLE COULD ALSO CAUSE IMPROPER GAME OPERATION, OR DAMAGE TO THE ELECTRONICS.

DO NOT DEFEAT OR REMOVE THE GROUNDING PRONG ON THE POWER CORD FOR THE SAME REASON AS GIVEN ABOVE. USING AN IMPROPERLY GROUNDED GAME COULD VOID YOUR WARRANTY.

HAVE A QUALIFIED ELECTRICIAN CHECK YOUR A.C. RECEPTACLE TO BE SURE THE GROUND IS FUNCTIONING PROPERLY.

## INSTALLATION

The game comes ready to play with just a few simple things to keep in mind.

1. Plug the game into the A.C. outlet and turn on power to the game. The switch for the game is located on a power module on the outside rear of the game.

THIS GAME IS DESIGNED TO DISSIPATE STATIC ELECTRICITY THROUGH THE GROUNDING PLANE OF THE GAME. IF THE A.C. GROUND DOES NOT WORK, THE GAME COULD DISCHARGE STATIC ELECTRICITY THROUGH THE GAME CIRCUITRY, WHICH COULD CAUSE DAMAGE.

2. Make sure the game is level after installation. It is necessary to make sure the game is level for safety concerns.
3. Check that the A.C. voltage rating on the back of the game matches the A.C. voltage of your location.

THE POWER SUPPLY IS NOT VOLTAGE ADJUSTABLE. TO OPERATE THE GAME AT VOLTAGES OTHER THAN THOSE IT WAS DESIGNED FOR. PLEASE CONTACT OUR SERVICE DEPARTMENT FOR VOLTAGE CONVERSION INFORMATION.

## WARNING

DO NOT remove any of the components on the main board (e.g. compact flash and eproms) while the game is powered on. This may cause permanent damage to the parts and the main board. Removing any main board component part while powered on will void the warranty.

**NOTE: THIS GAME IS INTENDED FOR INDOOR USE ONLY.**  
**ON THE BACK PANEL OF THE GAME: WARNING: SHOCK HAZARD - DO NOT OPEN. REFER SERVICING TO SERVICE PERSONNEL.**

# SETUP - INTRODUCTION

## Game play:

The player starts the game by moving the coin chute to skillfully drop their coin to light up the word "PLINKO". As the coin falls it is deflected off the pegs just like on the TV show. If the player is able to light the word "PLINKO", they are able to spin the big bonus wheel! Players receive tickets for coins that fall over the edge and in some cases, just for playing!

- Bonus wheel emulates "The Price is Right Big Wheel Spin".
- Playfield replicates the real "PLINKO!" board as seen on TV.
- Spell PLINKO! by lighting each letter for a chance to win the Big Bonus.
- Move coin chute back and fourth for skillful aiming.
- Win tickets for coins over the edge.
- Win tickets just for playing (Operator configurable).

## Features:

- Ability to set pre-lit letters.
- Ability to turn on chasing lights.
- Ability to set mercy tickets and coin over edge.
- Adjustable bonus feature (how much to apply toward the bonus).
- Easy slide pull out ticket door to access.
  - Ticket dispensers.
  - Coin and ticket meters.
  - Operator adjustments.
  - Error codes.
- High reliable playfield motor with 1 year warranty.
- Easy to program.
- Self error/fault checking.
- Slam security switch on each station.
- Tilt protection.
- Made in the USA.

# SETUP - ASSEMBLY

## METERS AND TICKET DISPENSER LOCATION

The coin and ticket meters are located in lower cabinet drawer of each station. Unlock both locks on each side and slide the drawers out. There you will find the ticket dispenser and meters.

## ACCESSING PROGRAMMING CONSOLE

The programming console unit pictured below has four buttons and a digital display screen. This is located in the left ticket and hopper drawer assembly. Unlock the two locks to slide the left drawer open. The console is located on the right side of that drawer only. Refer to page 19 for location. If any errors are encountered on either side they will be displayed on the screen. Refer to error codes in programming to understand and correct the errors. If no errors have been detected, the current software version will be displayed on the screen.

## PROGRAMMING

Press the "PROGRAM" button to enter programming mode. Press "SELECT UP" and "SELECT DOWN" to move the cursor to cycle through options. Press "ADVANCE" to change the settings the cursor is currently on. Press the "PROGRAM" button to exit programming and re-start the game.

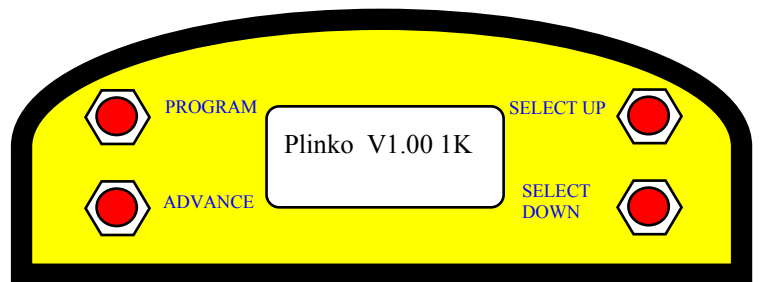
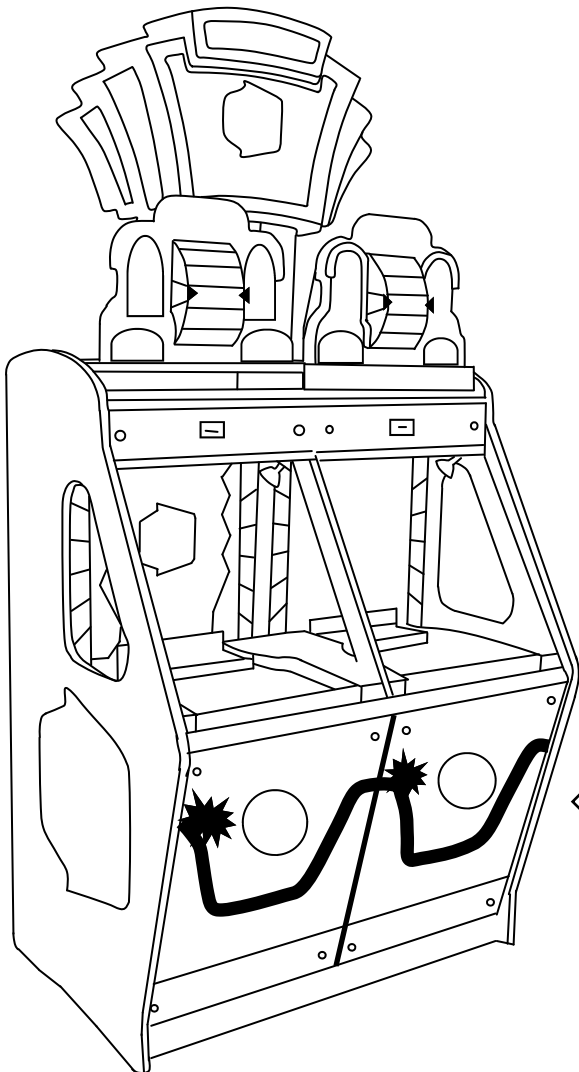

Programming console unit

Both cabinet drawers slide open to access the coin hopper, ticket dispenser, coin and ticket meters but only the left side has the programming console unit which programs both stations.

# PROGRAMMING YOUR PLINKO - Software game version 1.03 MO

OPTION	DESCRIPTION	DEFAULT	MIN	MAX
Game Volume	Game and attract Volumes	5	0	7
Music Volume	Music Volume only	5	0	7
Cylon	If set to 1 red LED must be lit to light letter	0	0	1
JFP	Tickets given when coin goes in	1	0	2
Edge	How many Tickets over the Edge	5	0	18
Bonus	How many tickets to the wheel kitty	4	2	18
Power On Lights	How many letters are lit when you turn power on	0	0	3
Attract Time	When it will say come on down.	3	0	30
Coin Dispense	How many coins to dispense per swipe (This option only in the card swipe version)	1		
Factory reset	Reset factory settings	0	0	1

**Cylon option defined:** The Cylon feature increases the difficulty to achieve the bonus wheel spin by limiting when the letters can be lit. When the LED moves back and fourth and a coin enters the chute for that letter, if the red LED is not correctly lit on that letter, the letter will not light.

## ERROR CODES

Error	Description		
.....7	L Ticket Err	Ticket dispenser empty	Fill with tickets
....6.	R Ticket Err	Right ticket dispenser empty\	Fill with tickets
...5..	Compact Flash Err	Cannot read compact flash	Replace CF
..4...	L Wheel Err	Cannot find home sensor	Check sensor
..3....	R Wheel Err	Cannot find home sensor	Check sensor
.2.....	Switch Board Comm Err	Cannot find cylon board	Check connection
1.....	R Switch Board Comm Err	Cannot find cylon board	Check connection

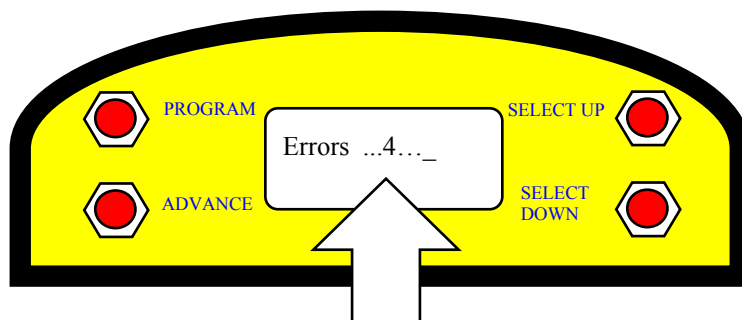

Errors will be displayed whenever they are encountered. A dot is shown when no errors are detected. The dot is replaced by the error number encountered. Multiple errors can be shown at the same time on the display. A display of ...45.. means that there is no response from the flash card and the wheel has missed home position. A display of .....7 means tickets dispenser has run out of tickets.

# SETUP - PLAYFIELD

It is recommended that you load at least 500 tokens onto the playfield (without any dropping into the hopper) in each station once you have located the final placement of this game. Begin by unlocking both locks and removing the coin chute assembly, you must unplug the coin sensor harness to completely remove the assembly, and put this aside. Remove the front glass and place aside. Insert coins into the two rows of risers as shown in figure 1. Make sure the coins are tightly packed from end to end. With the game powered on, drop handfuls of coins above the Plinko switches but behind the plastic shield. See figure 2. This will allow the coins to naturally build up onto the playfield simulating many plays by players in a very short amount of time.

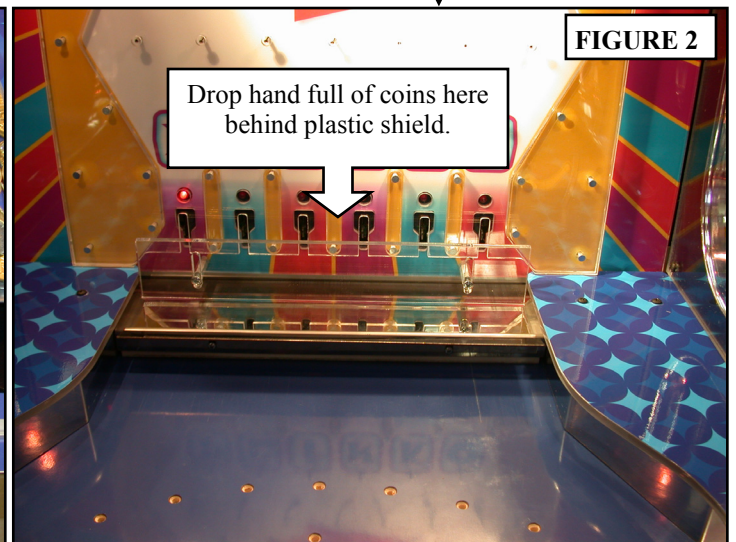
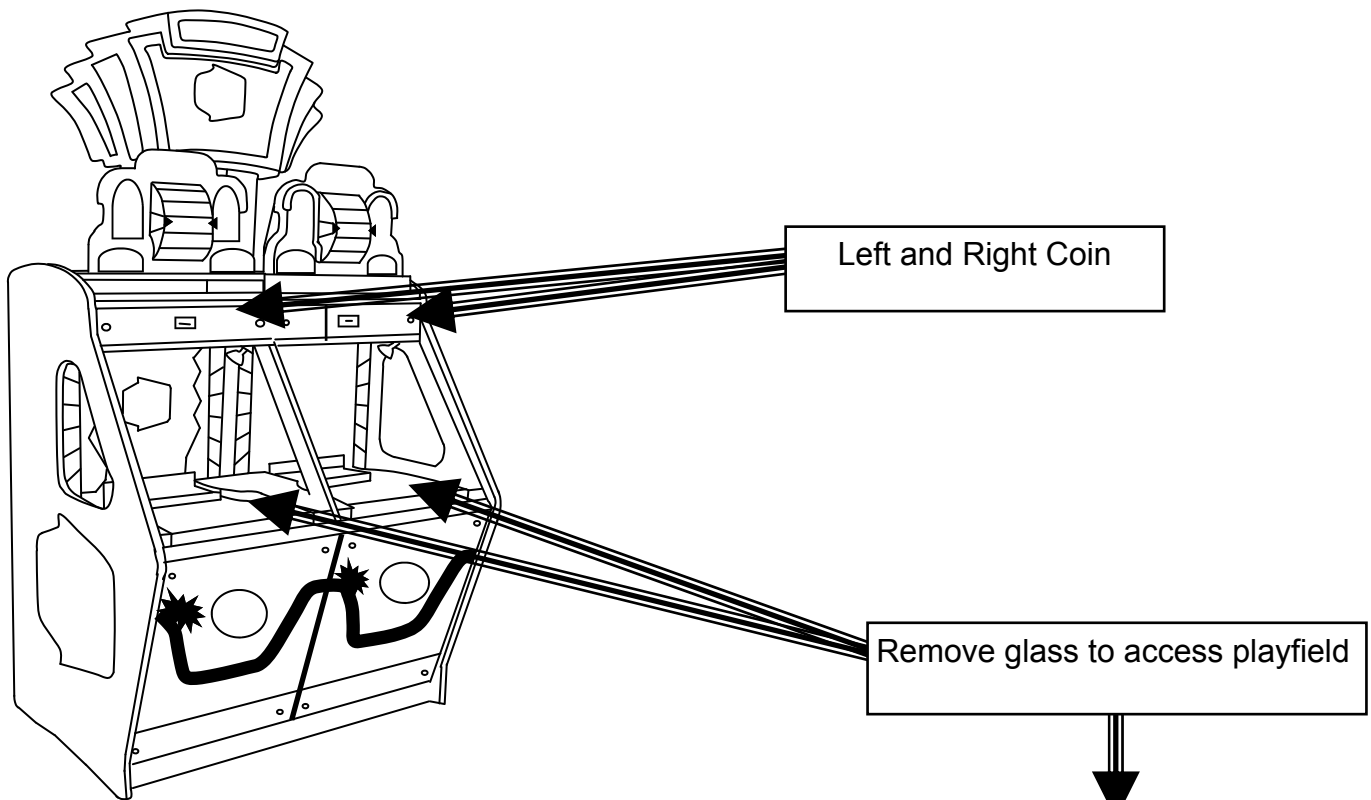

# TROUBLESHOOTING

## Security Tilt Bob & Slam Switches

This game employs two different security features to prevent players from collecting extra tickets. If the player slams the ticket drawer in an attempt to force coins to fall off the edge, the game will sound an alarm and end any current game in progress on that station. If the player rocks the entire cabinet a tilt Bob will trigger and it will immediately void any game in progress on both stations. The alarm will sound for a period of time in both occurrences.

The tilt Bob is accessed through the back of the game. The anti slam switches are located in the ticket access drawers. See diagrams below.

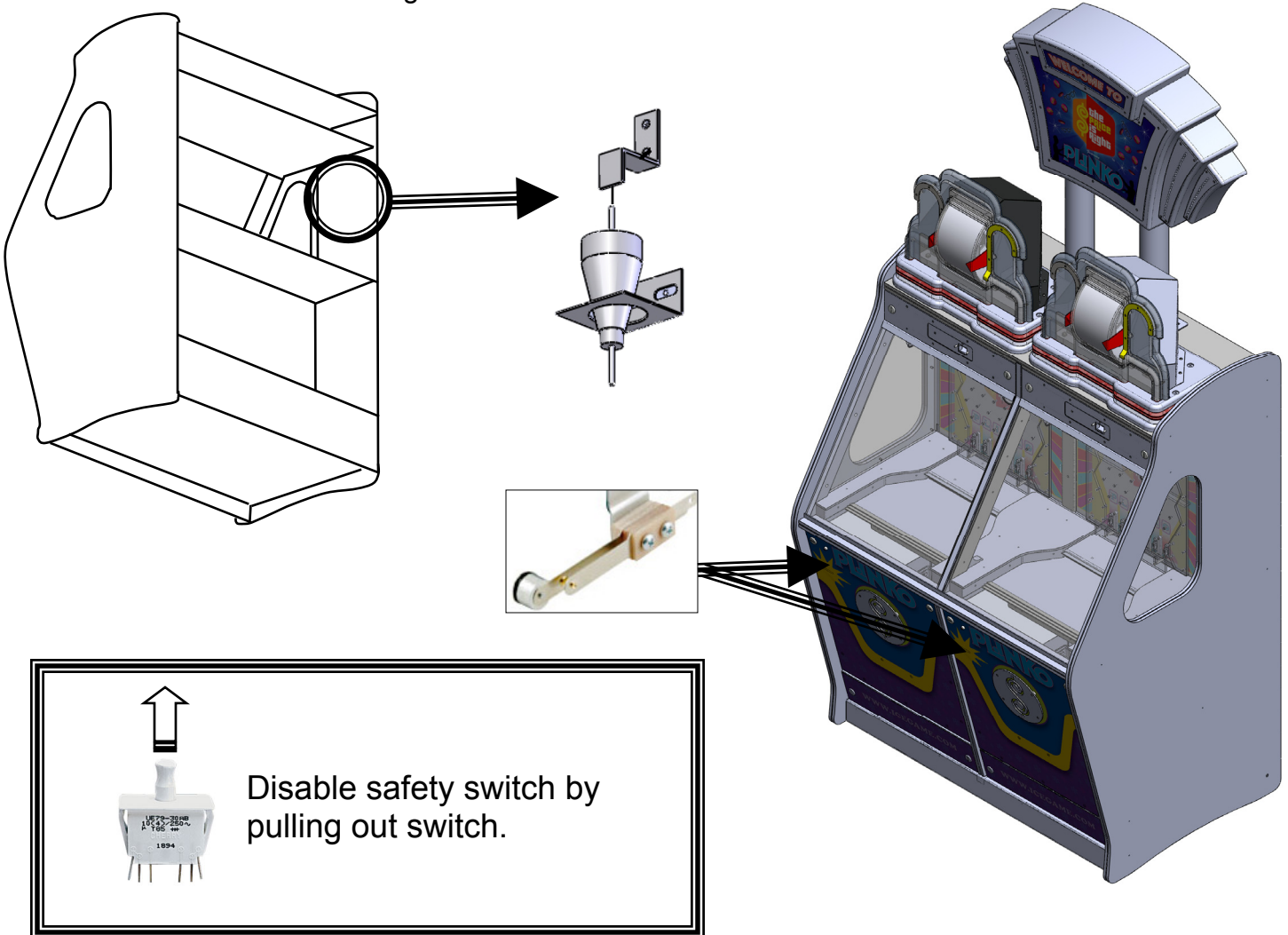

## AC Service switch

This game using a AC cutoff switch located in the back. When servicing the game if you remove the back cabinet panels with the power on, the deck pusher will stop. This is normal. If service is required with AC applied, pull the AC switch out which will allow power to the deck pushers. There one for each cabinet side.

**\*\*\* WARNING \*\*\* This ac cut off switch is for your safety as serious injury could result if disabled.**

# TROUBLESHOOTING

## Troubleshooting

### CAUTION

This game uses complex electronic components that are very sensitive to static electricity. Observe precautions below before handling these electronics. Failure to do so may void the warranty and damage electronic assemblies.

Before servicing electronics, turn off AC power to the game. Wait for capacitors to discharge.

DO NOT remove any of the components on the main board (e.g. compact flash and eproms) while the game is powered on. This may cause permanent damage to the parts and the main board.

Before touching or handling electronic assemblies, discharge static electricity on your body. To discharge this static, begin by connecting the line cord to a grounded outlet. Don't turn on the game. Next, touch the safety ground stud of the power supply chassis.

Store electronic assemblies in an anti-static area. Use anti-static bags to store or transport the game circuit boards.

Don't remove or connect electronic assemblies when cabinet power is on. Otherwise, you'll damage electronic assemblies and void the game's warranty.

After you complete maintenance or service, replace ground wires, shields, safety covers and install and tighten ground and mounting screw.

## Fuses - Main Power Supply

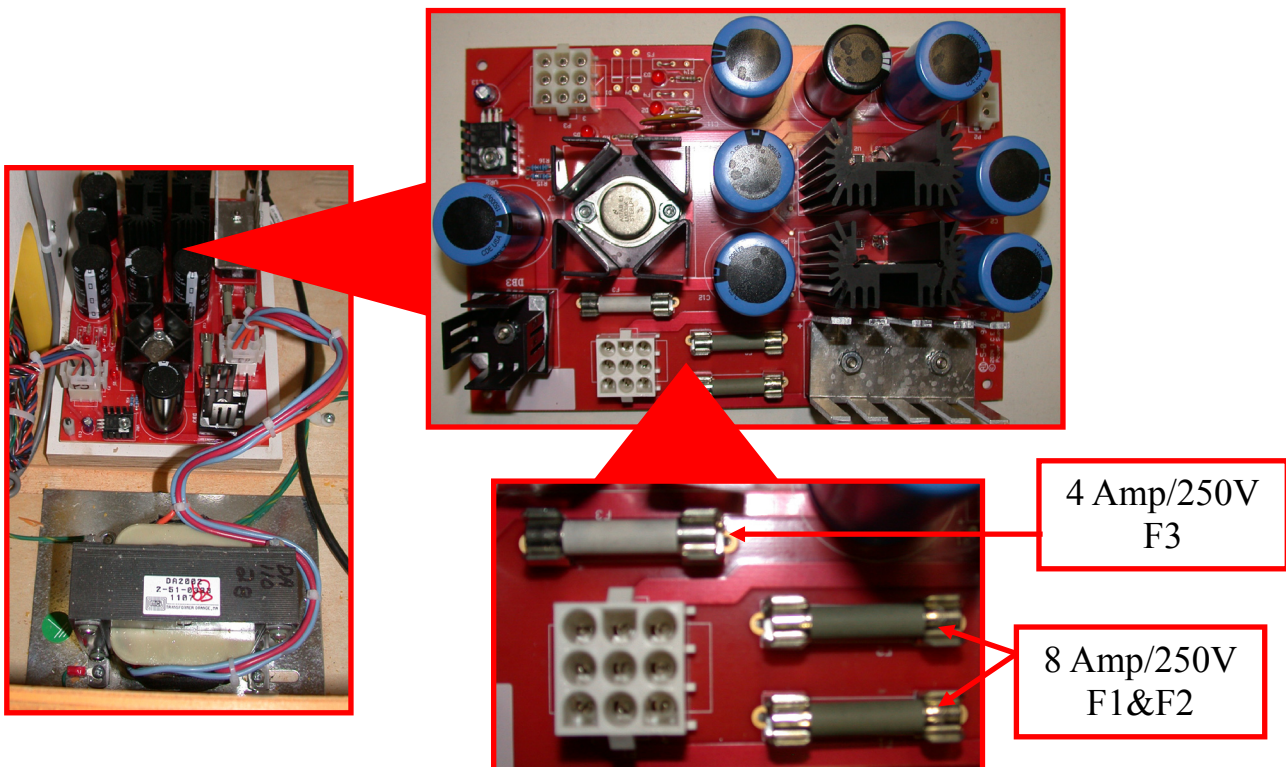

# ASSEMBLIES AND DIAGRAMS - PE1000X

ITEM NO.	PART NUMBER	DESCRIPTION	QTY.	ITEM NO.	PART NUMBER	DESCRIPTION	QTY.
1	PE3150CX	PUSHER CABINET	1	33	PE1194X	ORIENTAL MOTOR ASSEMBLY	1
2	PE1018	KICK PLATE TRIM	1	34	PE1035X	COIN EDGE MTG BRACKET	2
3	PE7107	DECAL-DIVIDER-LEFT	2	35	PE3220X	SHARK OPTP ASSEMBLY	1
4	PE7108	DECAL-DIVIDER-CENTER	1	36	DA2001X	PCBA (POWER SUPPLY)	1
5	PE3057X	FRONT PANEL ASSEMBLY	2	37	PE2034	PCBA (MAIN I/O)	1
6	SX2007X	ASY (POWER MODULE)	1	38	DA2002X	ASY TRANSFORMER 2-51-0333	2
7	PE3076X	PUSHER ASSEMBLY	1	39	MA1019	TRANSFORMER MTG PLATE	2
8	PE3068	PLAYFIELD SIDE SPACER NARROW .750	2	40	PC60628	6-32X1 3/4 PRHMS	12
9	PE3072	PLAYFIELD MIDDLE SPACER NARROW .750	1	41	PC60643	6-32 x 1/4 HH SPACER 14HTSP007	28
10	PE1020	PLAYFIELD SIDE A	2	42	MS2364X	FAN ASSEMBLY	1
11	PE1009X	CASH BOX ASSEMBLY	2	43	E02027G	FAN FINGER GUARD	2
12	PE1070	ANGLED LOCK PLATE	7	44	AM-M4-N		4
13	PE1028	GLASS TRIM LOWER	1	45	6031	#8 FLAT WASHER (ZINC)	12
14	PE1021	PLAYFIELD SIDE B	2	46	6004	CR-PHMS, #8-32 x 1/2" LG.	14
15	PE3028	FRONT GLASS	2	47	6493	8-32 X 25/64 THREADED INSERT	14
16	PE3027	SIDE GLASS	2	48	6109	6-32 x 1-1/4" LG. PPHMS	2
17	PE1060	TOP WIPER CHANNEL	1	49	6023	6-32 X 2.5" SRHMS	4
18	PE1061	UPPER WIPER CHANNEL CLAMP	4	50	6158	#6 FLAT WASHER	4
19	PE1013	COIN FUNNEL	2	51	6002A	6-32 NYLOCK NUT	5
20	#8	SQ. DRIVE WOOD SCREW	1	52	PreviewCfg	#8 FLAT WASHER (ZINC)	4
21	PE1071	ARCHED LOCK PLATE	4	53	655	#8 x 3/4 SQ. DRIVE (BLACK)	30
22	655S	#8 x 5/8 SQ. DRIVE (SILVER)	84	54	6466	1/4-20 X 2 FHMS	14
23	PE1006X	COIN CHUTE ASSEMBLY	2	55	6212	1/4 x 3/4 FLAT WASHER BLACK	4
24	PE1026X	HALOGEN BRACKET	4	56	6213	1/4-20 x 1-1/2" LG. BSHCS (BLACK, SEC.)	4
25	CR100110	BULB HALOGEN (12V/20W 36/38 DEG) (VC0157)	4	57	PE1050	14" DRAWER SLIDE	4
26	WS2039PEX	Shark Opto - PE VERSION	1				
27	PE1016	DOOR BRACKET	2				
28	PE3209	UPPER WIPER	2				
29	CP1051	TILT SENSOR	1				
30	WC1041	BRACKET (DOOR SWITCH/POD LATCH)	1				
31	2970	SWITCH (PUSH/PULL) CHERY E6930AO	1				
32	PE3052X	REAR DOOR ASSEMBLY	1				

# ASSEMBLIES AND DIAGRAMS

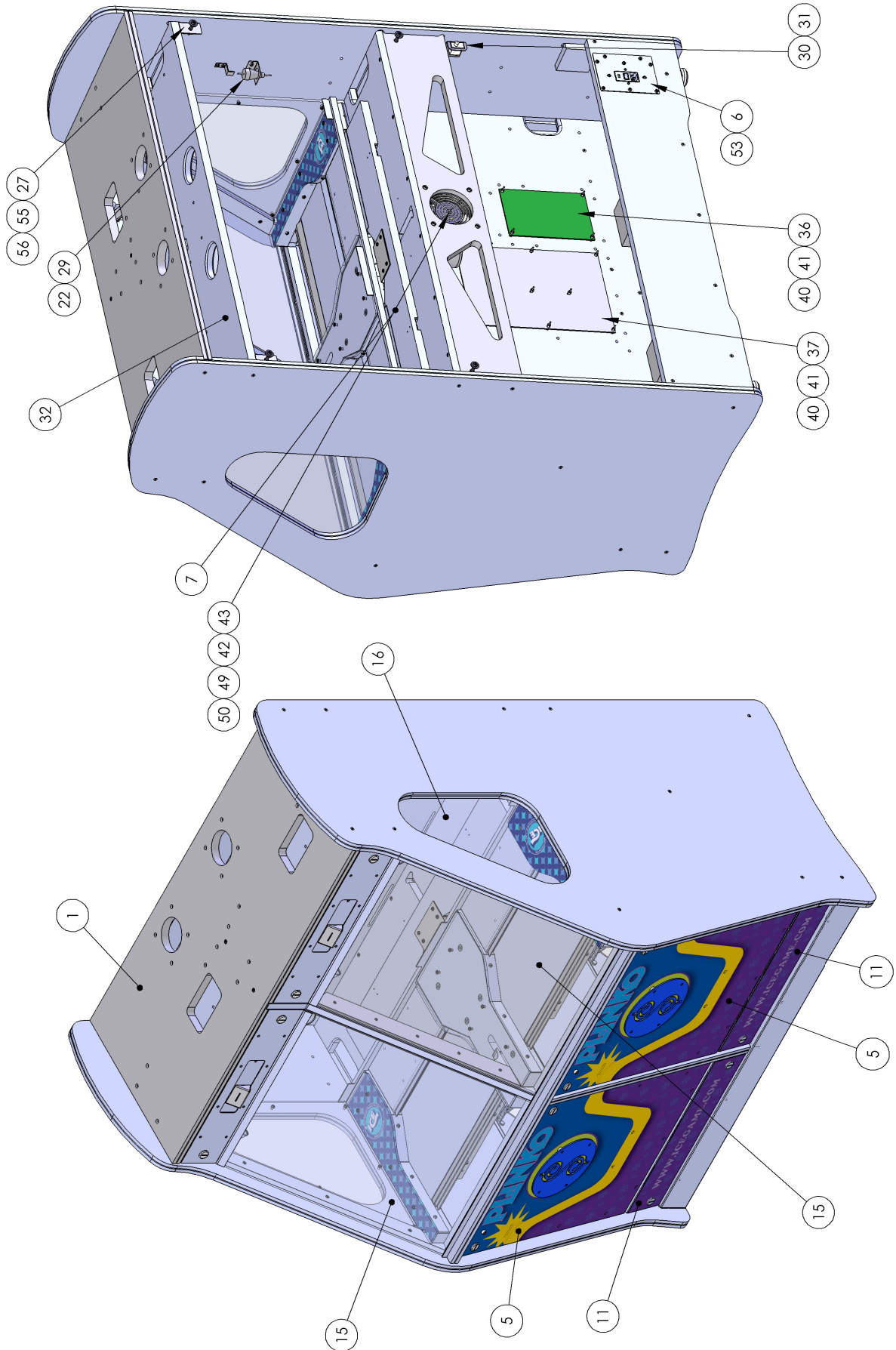

# ASSEMBLIES AND DIAGRAMS - PE3110X

ITEM NO.	PART NUMBER	DESCRIPTION	QTY.
1	PE3110	PRIZE WHEEL BASE	1
2	PE2008X	WHEEL MECH	1
3	PE3112	BONUS FRAME	1
4	PE1110	PRIZE WHEEL HOUSING	1
5	PE3120	WHEEL GLASS	1
6	PE1140	FRONT TRIM L	1
7	PE1141	FRONT TRIM R	1
8	PE1111	BONUS LED BRACKET	2
9	655	#8 x 3/4 SQ. DRIVE (BLACK)	6
10	6061	#8-32 CABINET INSERT	4
11	PE3113	PRIZE WHEEL FRONT TRIM	1
12	PE3115	PRIZE WHEEL FRONT	1
13	PE3123	PRIZE WHEEL LOWER BASE	1
14	PE3124	PRIZE WHEEL BASE LIGHT	2
15	PE3125	PRIZE WHEEL BASE COLOR	2
16	PE3126	PRIZE WHEEL BASE CLEAR	1
17	PE1118	POINTER	2
18	PE3119	PRIZE WHEEL FRONT MIRROR	1
19	PE3135	BONUS FRAME MIRROR	1
20	6072	8-32 NYLOCK NUT	4
21	6687	#6-19 X 1/2" LG. PHILIPS PAN HEAD PLASTITE SCREW	4
22	6279	8-32 ACORN NUT (ZINC)	4
23	6489	8-32 INSERT (FLUSH) 90267A563	2
24	6177	#8-32 x 1" LG PPHMS	2
25	6131	#10 SAE FLAT WASHER	2
26	6690	#6-19 X 5/8" LG. PHILIPS PAN HEAD PLASTITE SCREW	4
27	6088	1/4-20 x 3 HH BOLT (F-T)	4
28	PC60614	025-20 KEP NUT	4
29	6250	BHCS #8-32 x 7.5" LG. (BLACK)	4
30	6004a	8-32 KEP NUT	4
31	6031	#8 FLAT WASHER (ZINC)	4
32	PE7113	DECAL-WHEEL SURROUND	1
33	PE1088	LED BRACKET - "COME ON DOWN!"	1
34	E00442PEX	15 LED RIGID	1

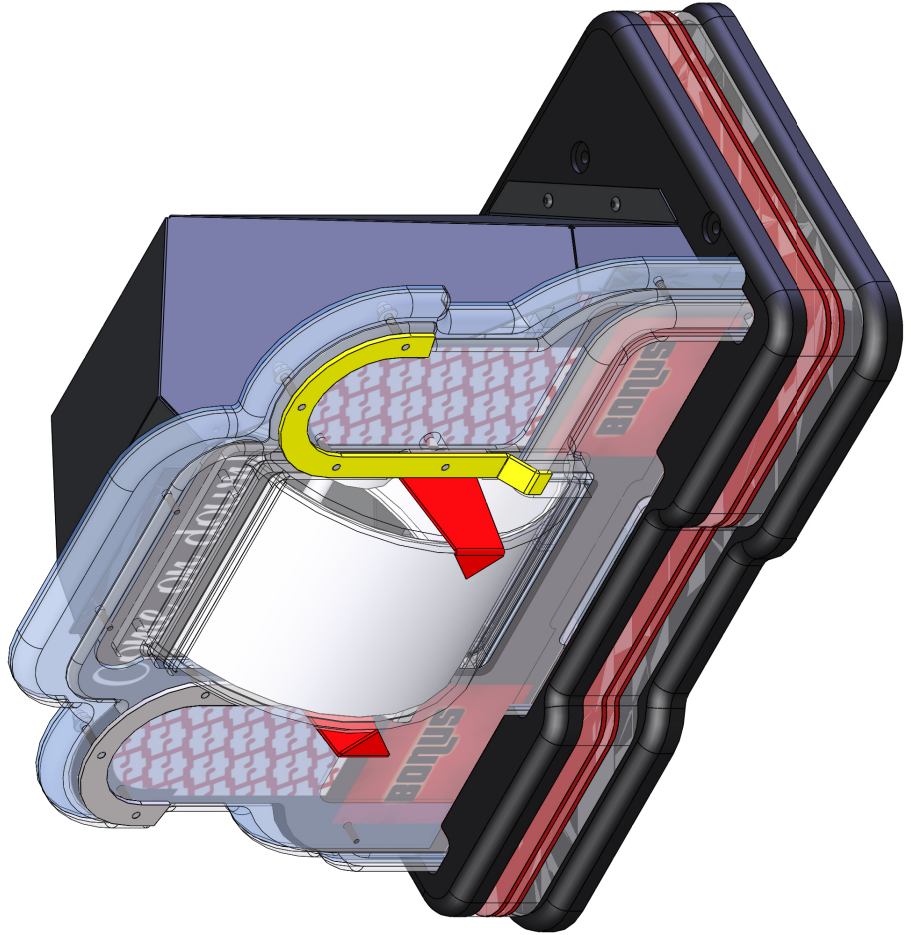

# ASSEMBLIES AND DIAGRAMS - PE3110X

NOTE: Adjust screw 24 to level wheel mech.

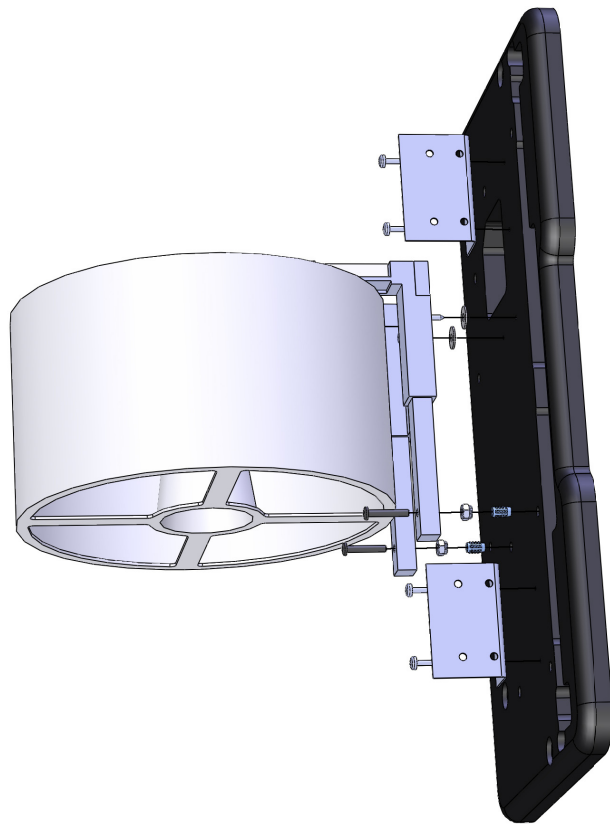
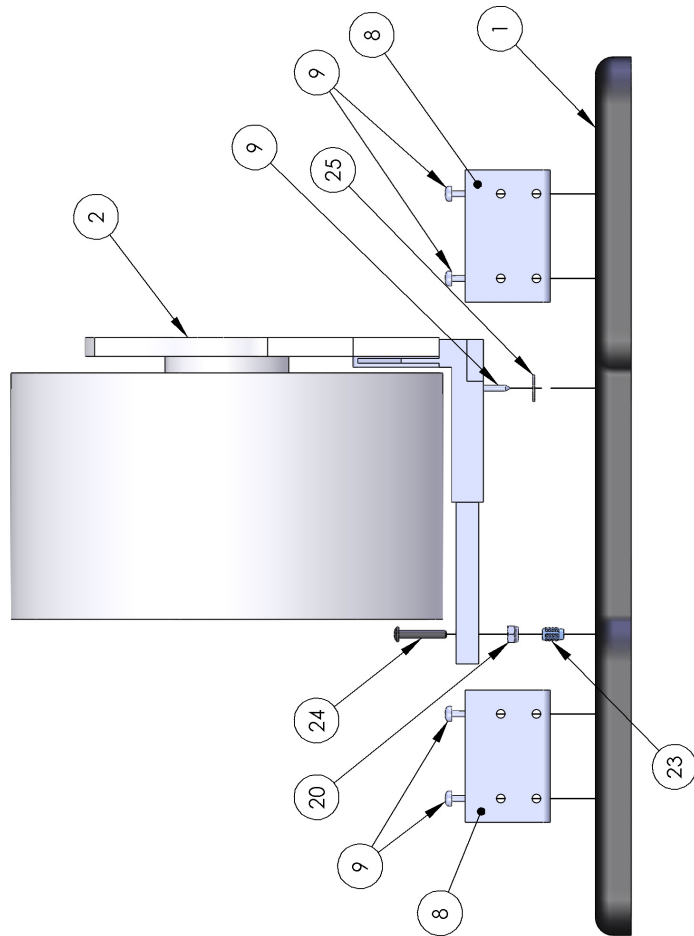

NOTE: THIS DRAWING SHOWS THE COMPONENTS USED TO CREATE THE LEVELING MECHANISM FOR THE WHEEL ASSEMBLY.

# ASSEMBLIES AND DIAGRAMS - PE3110X

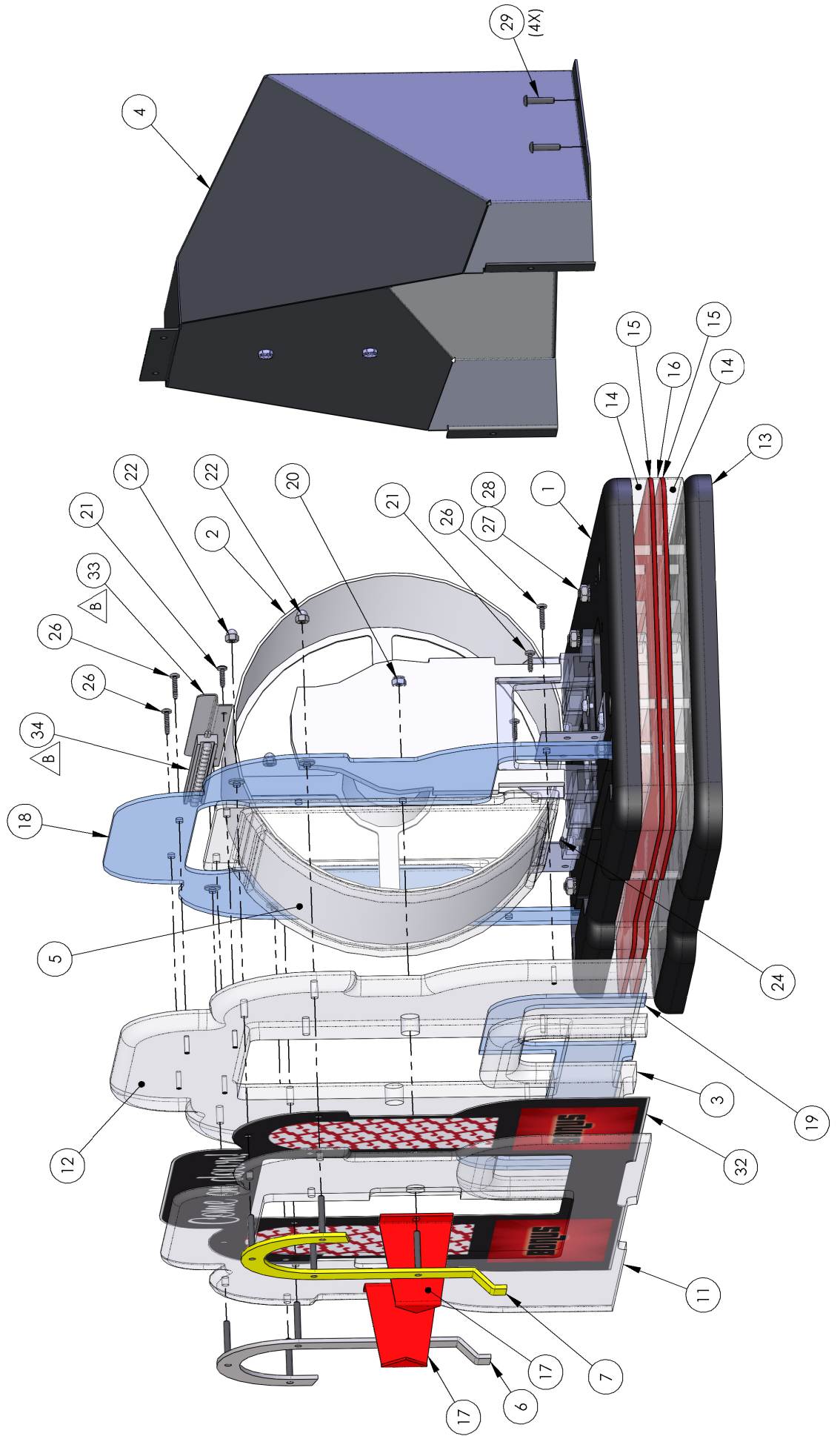

# 1006X Coin Chute Assembly

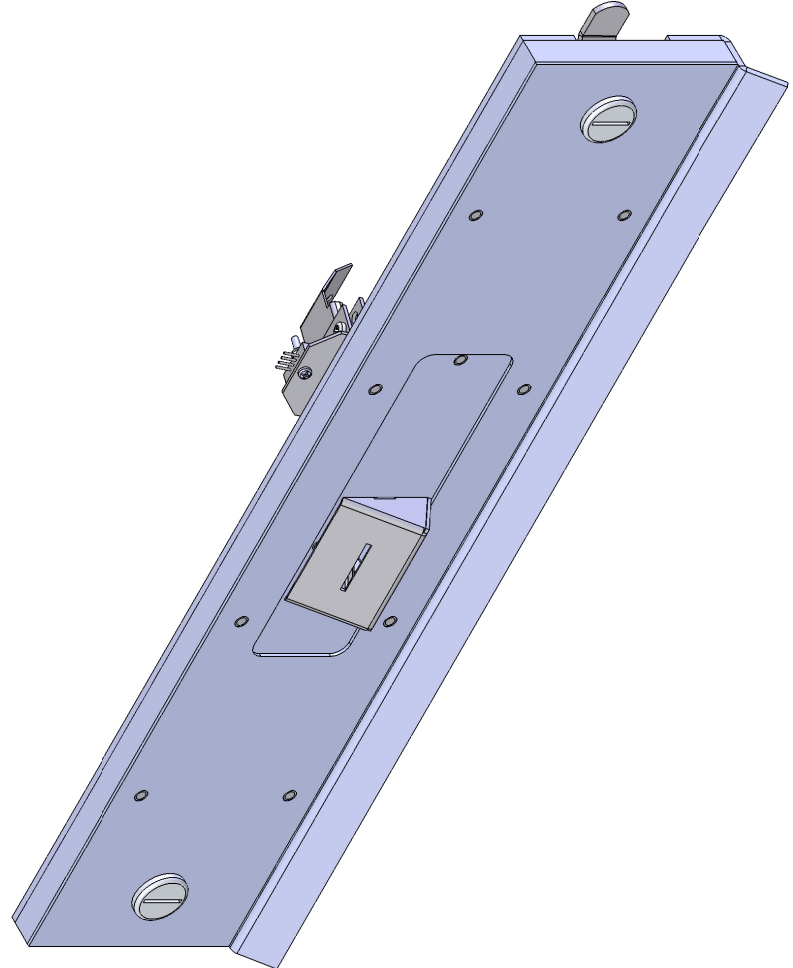

ITEM NO.	PART NUMBER	DESCRIPTION	QTY.
1	PE3078	COIN CHUTE BACK	1
2	PE1010	COIN CHUTE SLIDE PLATE	1
3	PE1006	COIN CHUTE FRONT PANEL	1
4	PE3006	COIN CHUTE SHUTTLE	1
5	PE1011	COIN CHUTE GUIDE RAIL	1
6	PE1012	REJECT COIN TRAY	1
7	6004a	8-32 KEP NUT	3
8	6691	M4 x 10 PPHMS	2
9	4002	BUMPER (#2953w) 9540K53	2
10	655	#8 x 3/4 SQ. DRIVE (BLACK)	2
11	6073	6-32 X 3/4 PPHMS	3
12	6060	4-40 X 3/4 PPHMS	1
13	PE1029	COIN CHUTE GLASS TRIM	1
14	6072	8-32 NYLOCK NUT	8
15	6086	HJNUT 8-32	1
16	E00436PEX	ASY (COIN IN SENSOR)	1
17	PE1081	COIN SENSOR BRACKET CLAMP	1
18	Coin Chute (see sales order)	COIN CHUTE	1
19	5014	7/8" CAMLOCK	2
20	PE1080	COIN CHUTE SENSOR BRACKET	1
21	6489	8-32 INSERT (FLUSH) 90267A563	1

# PE1006X Coin Chute Assembly

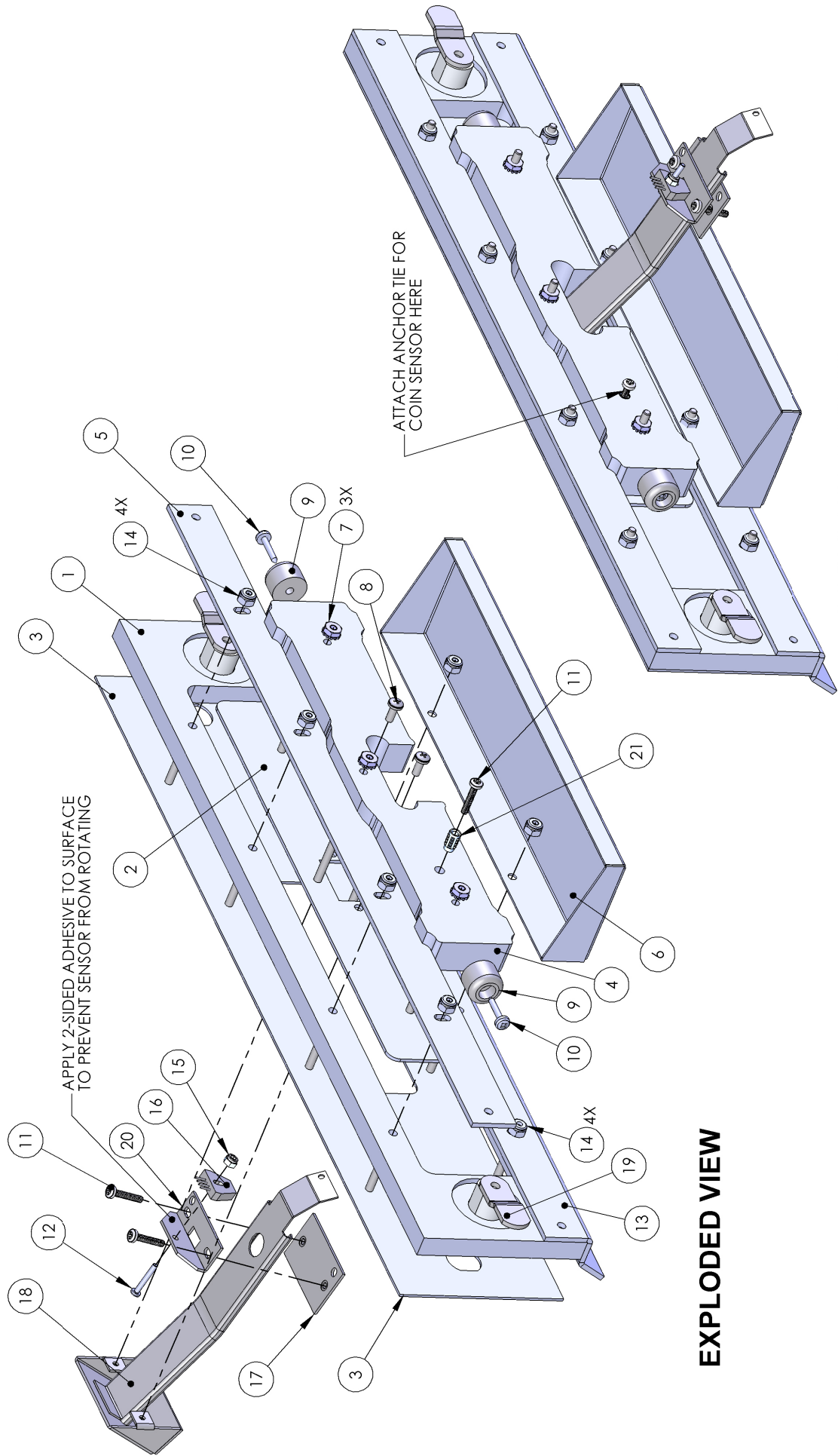

# ASSEMBLIES AND DIAGRAMS - PE3057X

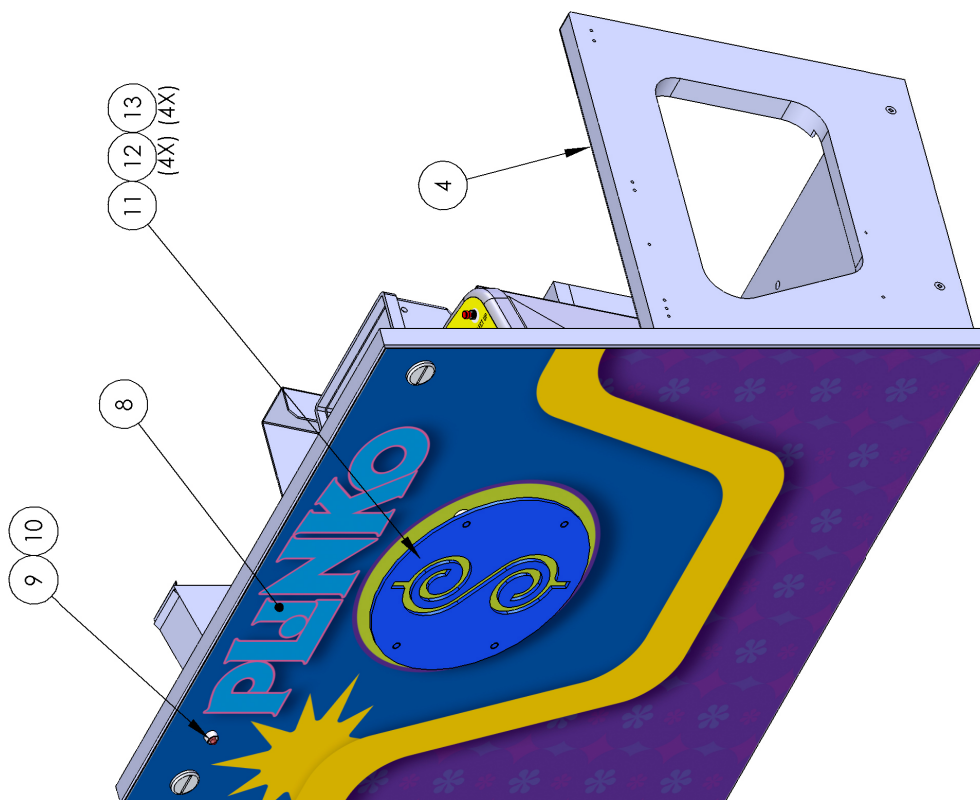

ITEM NO.	PART NUMBER	DESCRIPTION	QTY.
1	CR070113	HOPPER CUBE MKII .870-.937	1
2	1024	TICKET BIN (DOUBLE)	1
3	HH5005D	TICKET DISPENSER (DELTRONICS)	1
4	PE3057CX	CABINET ASSEMBLY-FRONT DOOR	1
5	AR2007	6 X 9 SPEAKER	1
6	655S	#8 x 5/8 SQ. DRIVE (SILVER)	18
7	1026	BRACKET LOW TICKET SWITCH MOUNT	1
8	PE7157	DECAL - FRONT DOOR	1
9	E01017	8212 LED HOLDER	1
10	E08212	(ROHS) LED RED FLASHING	1
11	PE1150	PLINKO SPEAKER COVER	1
12	6305	SPACER, NYLON 1/2x.260x1/4L	4
13	6040	10-24 KEP NUT	4
14	PE3011X	PROGRAMMING PANEL	1
15	6189	#4 x 1" LG. PH PAN TY AB SCREW	2
16	5014	7/8" CAMLOCK	2
17	PE1056	COIN OVERFLOW	1

# ASSEMBLIES AND DIAGRAMS - PE3057X

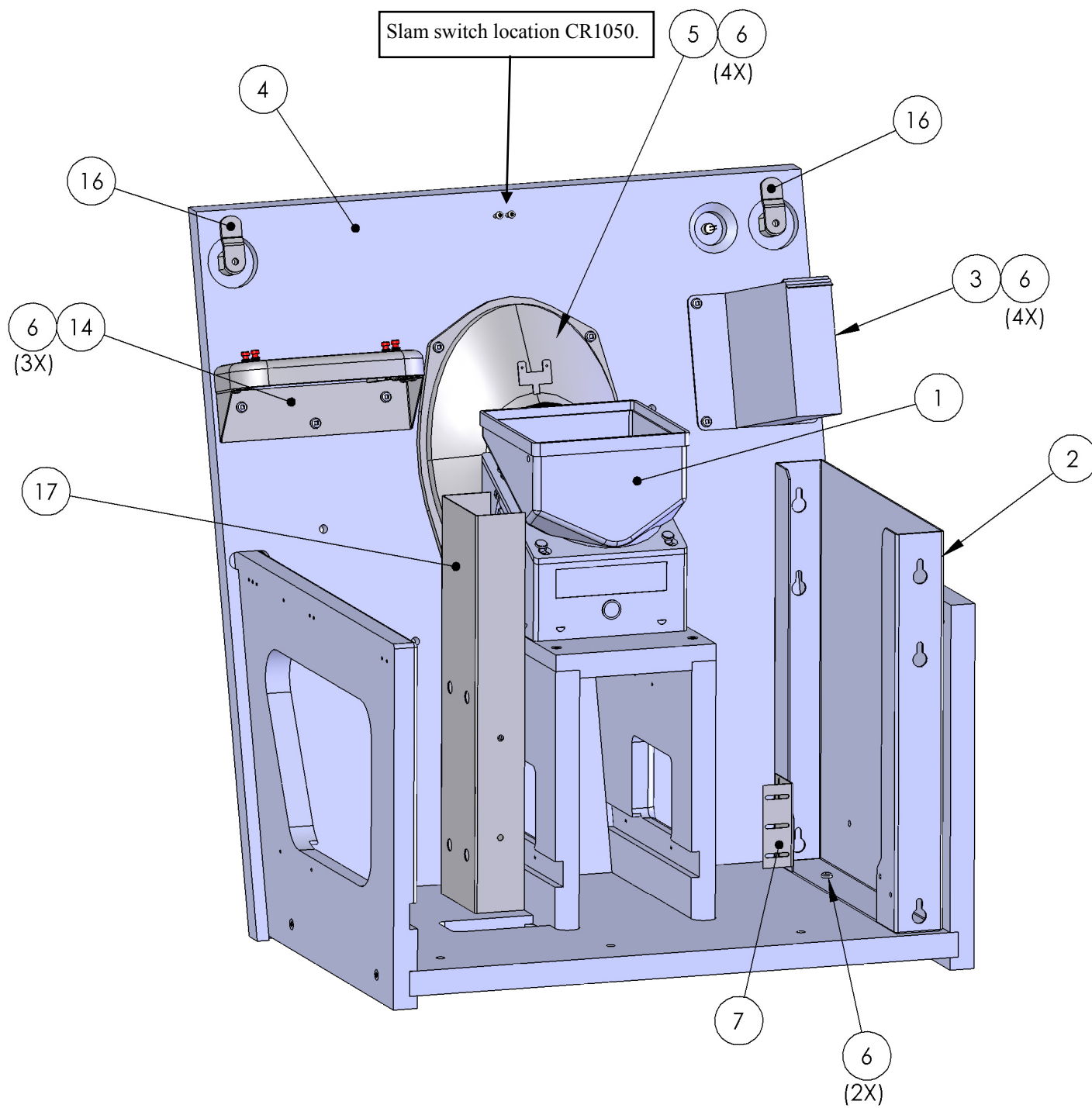

# ASSEMBLIES AND DIAGRAMS - PE3011X

ITEM NO.	PART NUMBER	DESCRIPTION	QTY.
1	2289X	ASY (RESET BUTTON)	4
2	PE3011	PROGRAMMING PANEL FACE	1
3	PE1096	PROGRAMMING PANEL BRACKET	1
4	E00433	LCD Module 16 x 2	1
5	6071	#6 x 1/2" LG. SELF-TAP (BLACK)	4
6	6294	Nylon Spacer	4
7	6199	#2 X 1/2" LG. PPHMS	4
8	PE7158	DECAL - PROGRAMMING ASSY	1
9	E00435	HEADER .100 DUAL ROW 16-PIN ST	1

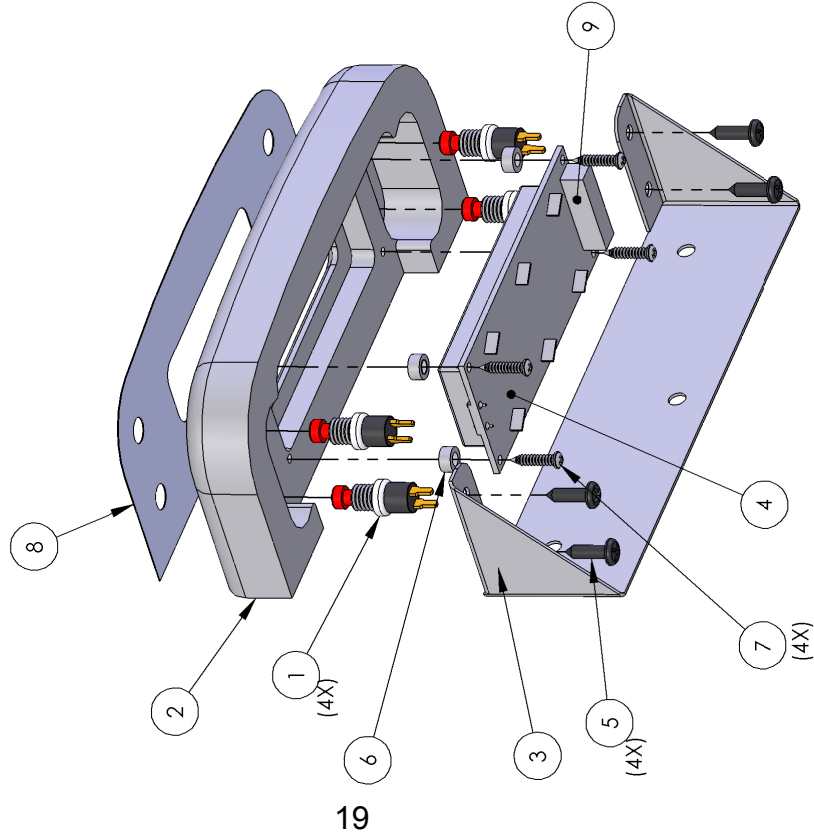

EXPLODED VIEW

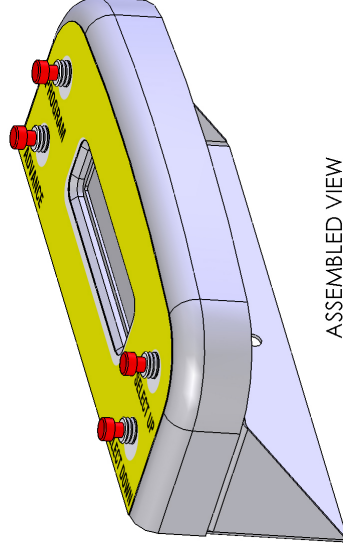

ASSEMBLED VIEW

# 1009X Coin Drawer Assembly

ITEM NO.	PART NUMBER	DESCRIPTION	QTY.
1	5014	LOCK (710-010-01B)	2
2	PE3056	CASH BOX FRONT	1
3	PE1009	CASH BOX	1
4	655	#8 x 3/4 SQ. DRIVE (BLACK)	7
5	PE7156	CASH BOX GRAPHIC	1

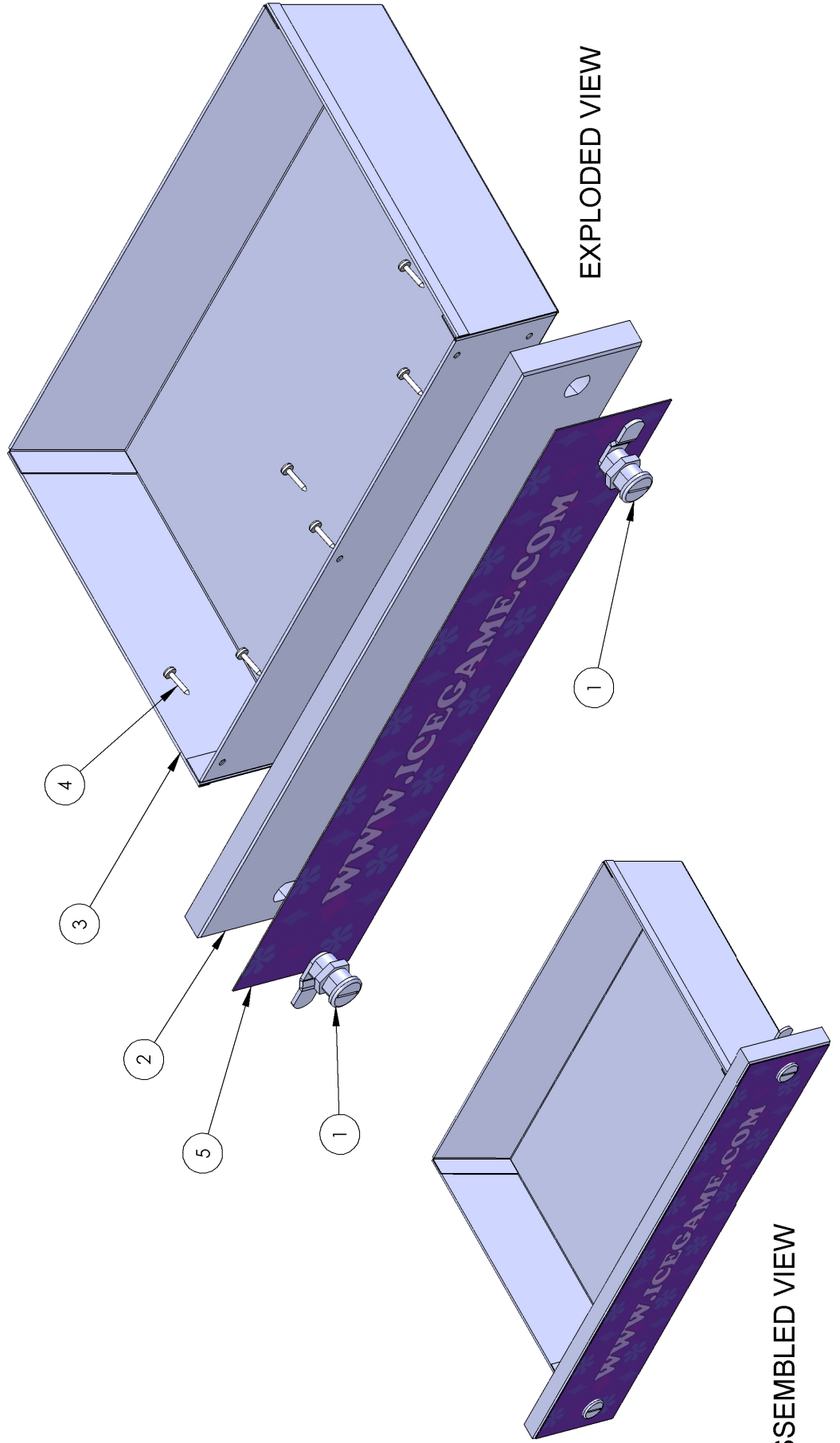

# 3130X Back Playfield Assembly



ITEM NO.	PART NUMBER	DESCRIPTION	QTY.
1	PE7130	DECAL-PLAYFIELD	1
2	PE2035X	PCBA (OPTO SWITCH)	1
3	PE3133	PLINKO DIVIDER	5
4	PE3132	PLINKO SIDE	2
5	6686	3/32 X 9/16	40
6	PE2036X	PCBA (LED DISPLAY)	1
7	PC60643	6-32 x 1/4 HH SPACER	12
8	PE3136	COIN LEVELER	1
9	6127	6-32 x 1 HH METAL SPACER	2
10	SK624	6-32 KEP NUT	25
11	656	6-32 x 3/4 PEM STUD (ROHS) (FH-632-12Z1)	22
12	6002	6-32 x 1/2" LG. PPHMS	4
13	6146	6-32X2 PRHMS	3
14	6203	FH-632-20	3
15	6158	#6 FLAT WASHER	22

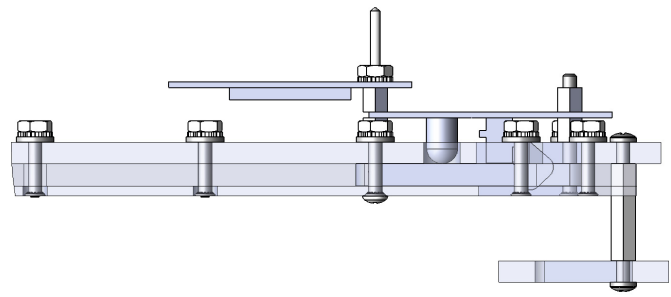
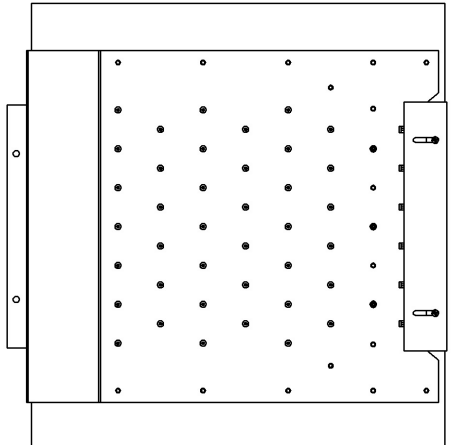
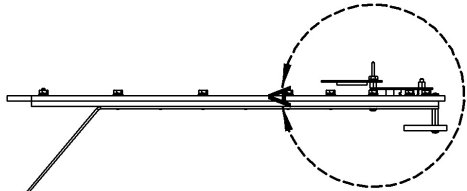
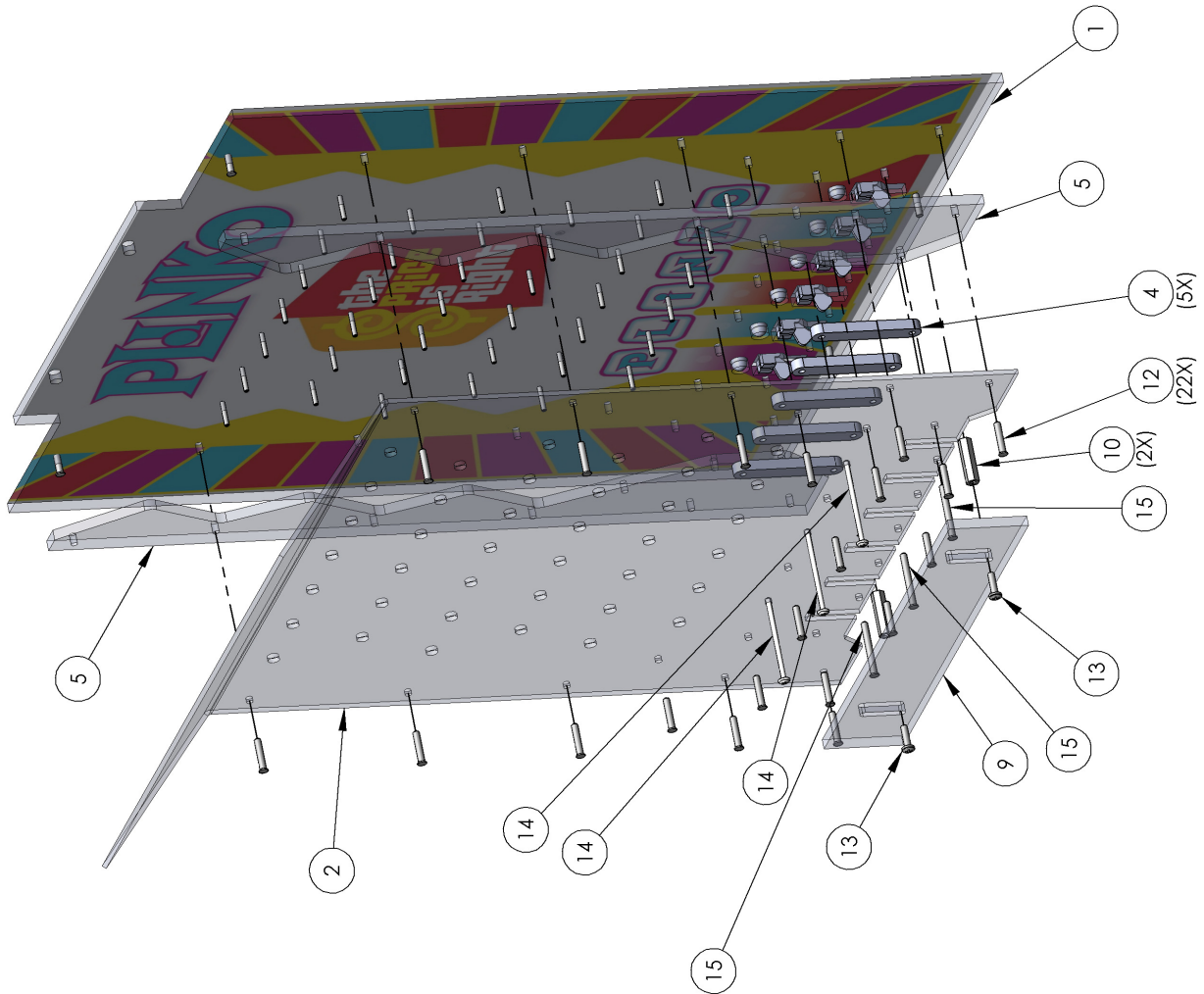

# 3130X Back Playfield Assembly

DETAIL A  
SCALE 1 : 2

# 3130X Back Playfield Assembly

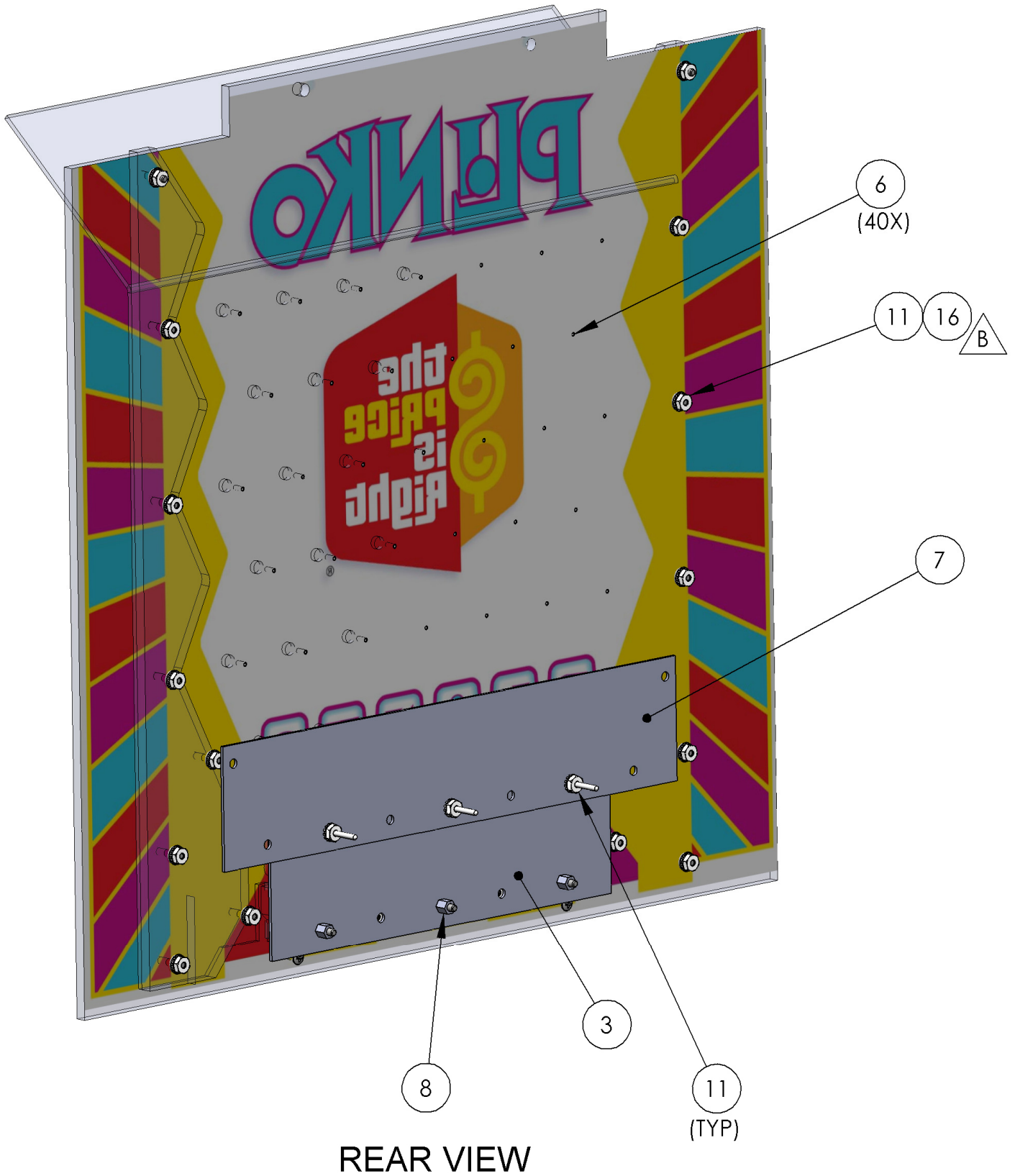

# 3076X Assembly

ITEM NO.	PART NUMBER	DESCRIPTION	QTY.
1	PE3076	PUSHER BASE	1
2	PE3008	LOWER WIPER	2
3	PE1042	PUSHER EDGE	2
4	PE1041	PUSHER DECK	2
5	6189	#4 x 1" LG. PH PAN TY AB SCREW	4
6	6442	1/4 OD x 5/16 #6 NYLON UNTHREAD ROUND SPACER	4
7	6031	#8 FLAT WASHER (ZINC)	8
8	6002A	6-32 NYLOCK NUT	8
9	CR060008S	SLIDE PUSHER DECK (SL3178) SILVER	2
10	6071	#6 x 1/2" LG. SELF-TAP (BLACK)	8
11	PE1019	PUSHER DECK CAM CHANNEL	1
12	6061	#8-32 CABINET INSERT	4
13	6004	CR-PHMS, #8-32 x 1/2" LG.	4

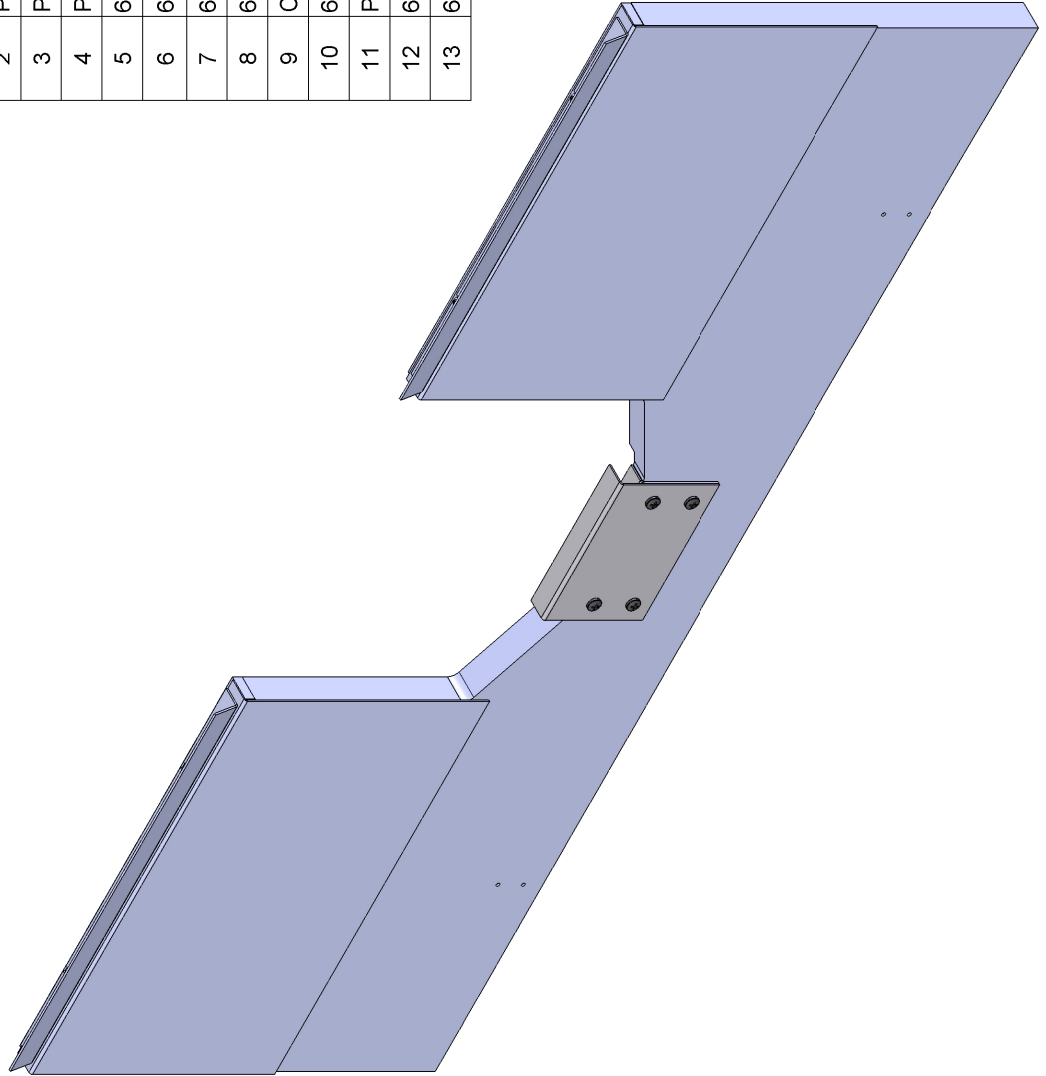



# 1100X Assembly

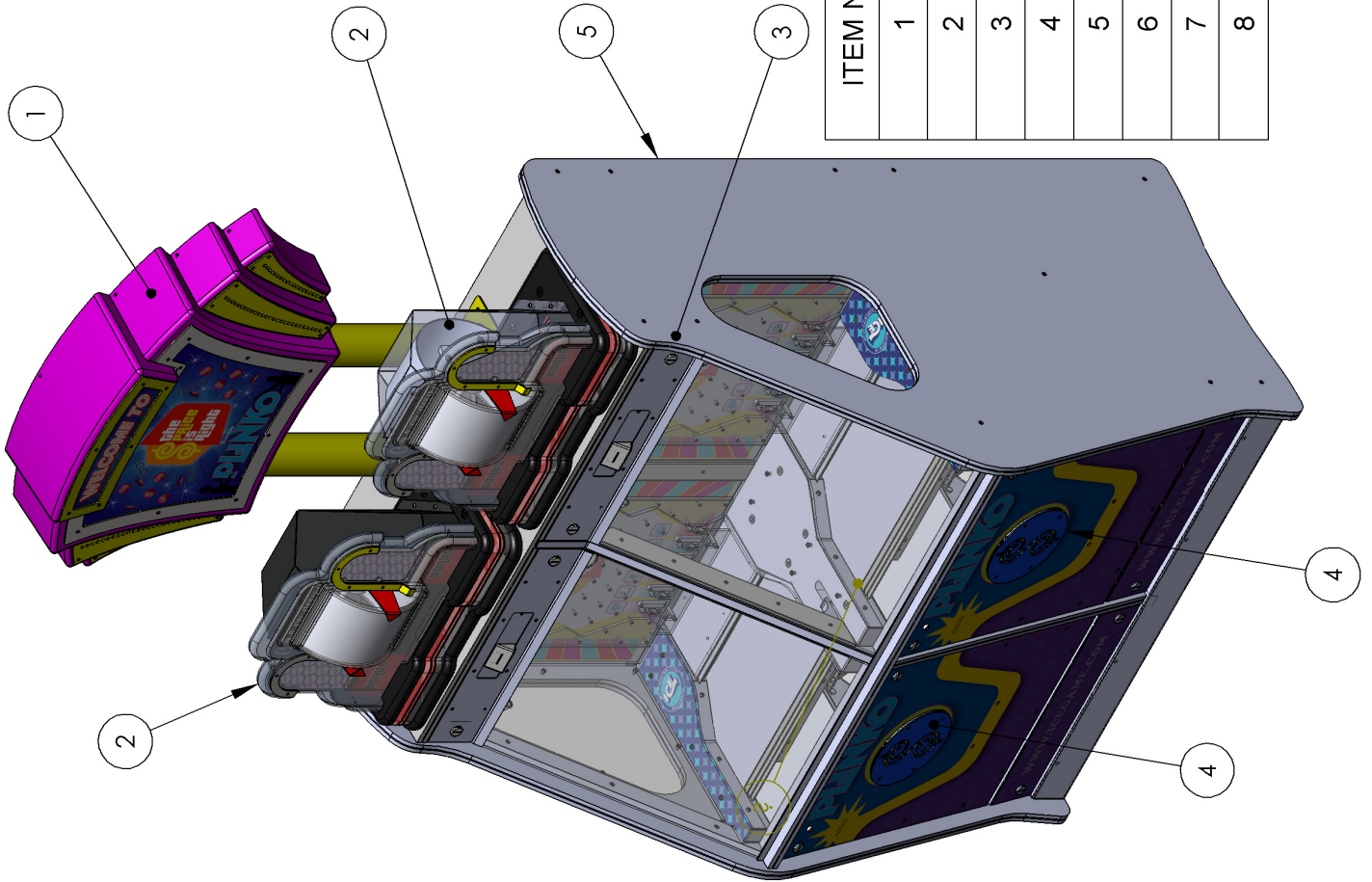

ITEM NO.	PART NUMBER	DESCRIPTION	QTY.
1	PE3127X	MARQUEE ASSEMBLY	1
2	PE3110X	PRIZE WHEEL ASSEMBLY	2
3	PE3130X	PLINKO ASSEMBLY	2
4	PE1150	PLINKO SPEAKER COVER	2
5	PE1000X	PUSHER CAB ASSEMBLY	1
6	PE3067	FRONT GLASS SUPPORT	2
7	PE1160	CENTER COVER	1
8	PE3109	CENTER DIVIDER CLIP	2

ITEM NO.	PART NUMBER	DESCRIPTION	QTY.
1	PE3160	MARQUEE BACK	1
2	PE3161	MARQUEE DOOR	1
3	PE3162	MARQUEE UPPER RIB	1
4	PE3163	MARQUEE LOWER RIB	1
5	PE3127	MARQUEE VAC FORM	1
6	5014	LOCK (710-010-01B)	1
7	PE7129	MARQUEE 2 PLAYER 'UPPER'	1
8	PE1131	MAIN TRIM	1
9	PE1130	UPPER TRIM	1
10	PE1132	SMALL SIDE TRIM L	1
11	PE1133	SMALL SIDE TRIM R	1
12	PE1134	SIDE TRIM L	1
13	PE1135	SIDE TRIM R	1
14	PE1128	MARQUEE SUPPORT WELDMENT	2
15	CP1038	TILT PANEL HINGE	1
16	655S	#8 x 5/8 SQ. DRIVE (SILVER)	12
17	TG1021	LIGHT BRACKET	3
18	SH2130X	ASY (2D BULB SOCKET)	3
19	E00382	BULB CF 27W (PHILIPS #EL/MDT27W)	3
20	655	#8 x 3/4 SQ. DRIVE (BLACK)	7
21	PE7128	MARQUEE 2 PLAYER 'MAIN' LOGO	1

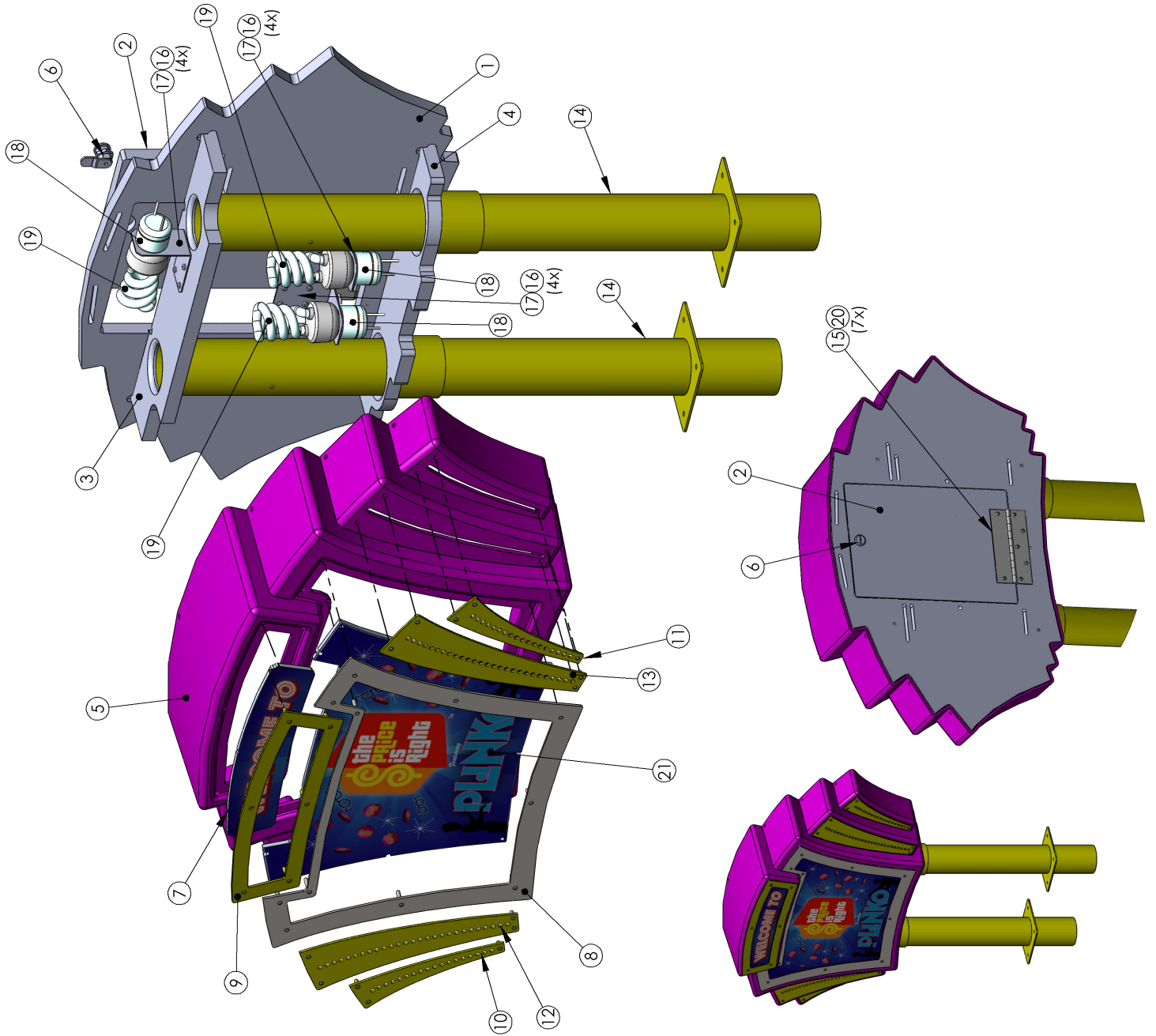

# 3127X Assembly

# PARTS LISTINGS

## Misc. Parts

XBFP9062359	Coin Chute .984
PE1050	Drawer Slide
PE3027	Side glass
PE3028	Front glass
1024	Ticket Bin
1026	Bracket for low ticket switch
PE3127X	Marquee 2 player
CR060008S	Slide pusher deck
SX2002AX	Assembly transformer

## Electrical Parts

CG2027	Power cord 9' 10"
CR100110	12v 20w 36/38 Halogen Bulb
CP1051	Tilt Sensor
DA2001X	Main Power Supply
DA2002X	Transformer for Main power supply
E02027G	Fan Guard
E02970	Cherry push/pull switch
MS2764X	Small fan assembly
PE2009A	Gearbox
PE2009X	Motor Assembly
PE2034X	Main I/O
AR2007	Speaker 6x9
CR070113A	Hopper Cube MKII .950 to 1"
CR1050	Anti-slam switch
E00211	Low Ticket switch
HH5005	Ticket Dispenser
2289X	Reset assembly button
E00433	LCD Module 16x2
E00411PEX	Red LED strip
E00414PEX	Blue LED strip
PE2008X	Bonus Wheel Assembly
PE2035X	Opto Switch
PE2036X	LED display
PE8520X	Socket for Halogen
SX1026-P802	Fan Coverl
SX2007X	Power module
E00436PEX	Coin in sensor

## Graphics and Decals

PE7158	Decal - Programming assembly
PE7157	Decal - Front door
PE7110	Decal - Wheel Reel
PE7113	Decal - Wheel Surround
PE7114	Decal - Wheel surround gold
PE7100	Decal - Cabinet lower side
PE7102	Decal - PC Board
PE7107	Decal - Left Divider
PE7109	Decal - Right Divider
PE7156	Decal - Cash box front drawer
PE7116	Decal - Corner Glass
PE7104	Decal - Instructions 'Cylon eye' version
PE7105	Decal - Instructions 'Standard' version

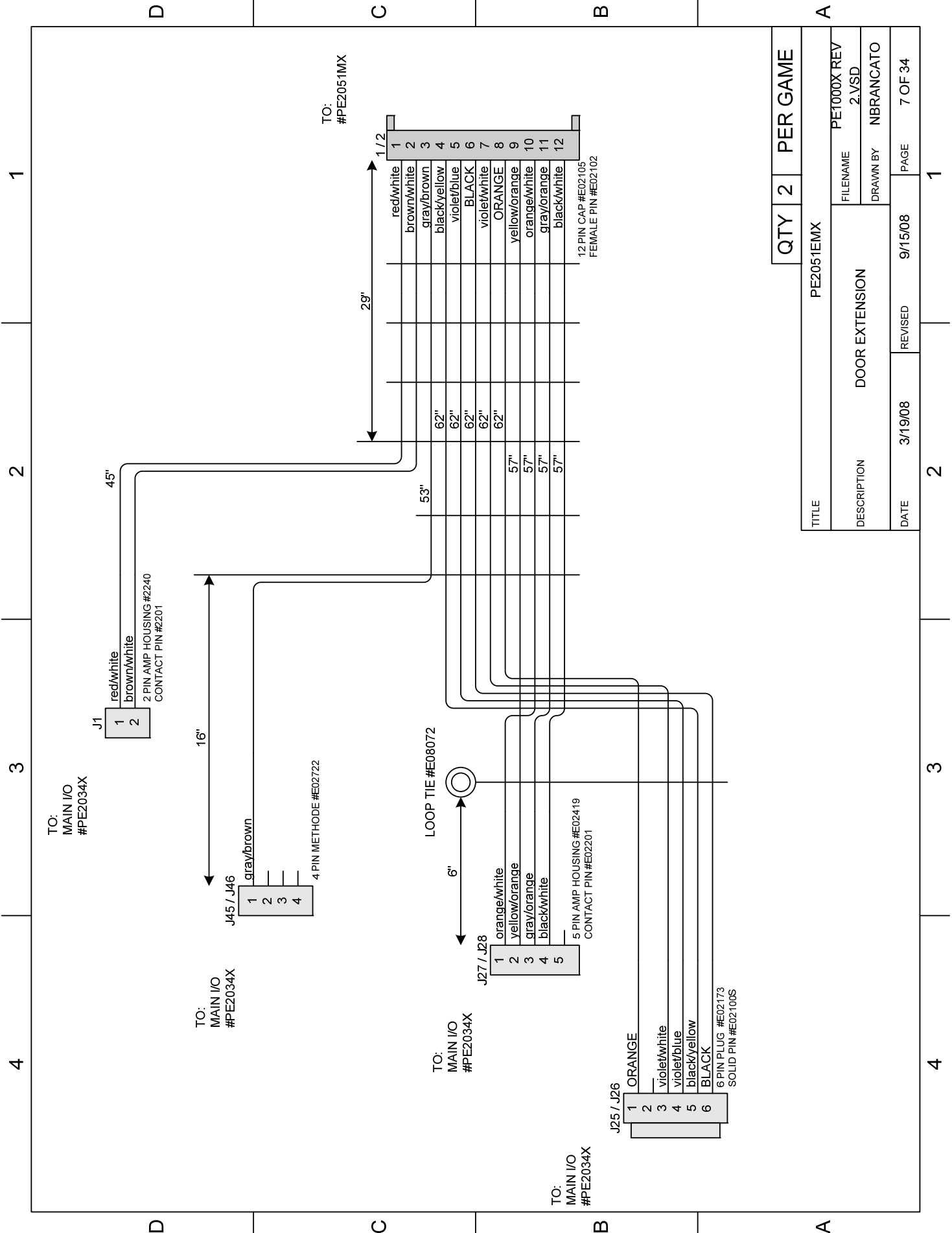

QTY 2		PER GAME
PE2051EMX		
FILENAME	PET100X REV 2.VSD	
DESCRIPTION	DOOR EXTENSION	
DATE	REVISED	PAGE
3/19/08	9/15/08	7 OF 34
DRAWN BY		NBRANCATO



4 3 2 1

D C B A

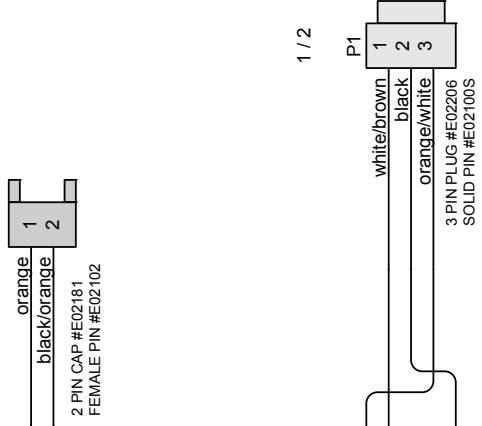

PE

J15 / J16

- 1 orange
- 2 orange/white
- 3 white/brown
- 4 black/orange
- 5 black
- 6 black
- 7 black
- 8 black
- 9 black

9 PIN PLUG #E02282  
SOLID PIN #E02100S

1 / 2

P1

- 1 white/brown
- 2 black
- 3 orange/white

3 PIN PLUG #E02206  
SOLID PIN #E02100S

TITLE	PE2052LX	QTY	2	PER GAME
-------	----------	-----	---	----------

DESCRIPTION	COIN INPUT	FILENAME	PE1000X REV 2.VSD
DATE	3/19/08	DRAWN BY	NBRANCATO
REVISED	9/15/08	PAGE	9 OF 34

4 3 2 1

4 3 2 1

D

C

B

A

PE

OP1

- 1 gray/brown
- 2 gray/red
- 3
- 4
- 5 gray/orange
- 6 gray/yellow

6 PIN CST-100 #E08634  
CONTACT PIN #E00383

7"

- 1
- 2
- 3
- 4

- 1 gray/brown
- 2 gray/red
- 3 gray/orange
- 4 gray/yellow

4 PIN MINI MOLEX PLUG #  
MALE PIN #

QTY 2 PER GAME

TITLE	PE2053ELX		
DESCRIPTION	COIN OPTO HARNESS	FILENAME	PE1000X REV 2.VSD
DATE	3/19/08	DRAWN BY	NBRANCATO
REVISED	9/15/08	PAGE	10 OF 34

4 3 2 1

D

C

B

A

4 3 2 1

D C B A

14"

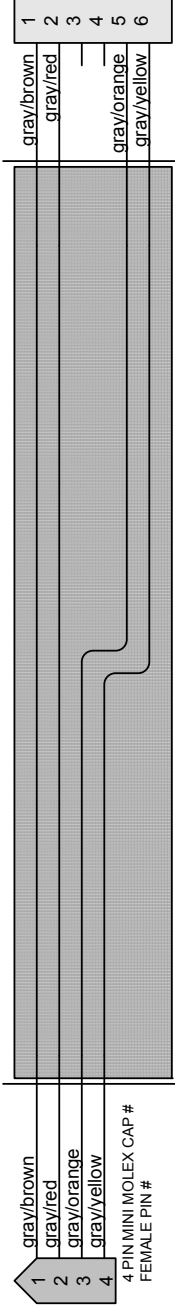

SHRINK TUBE

TITLE		PE2053LX	
DESCRIPTION		COIN OPTO HARNESS	
DATE	3/19/08	REVISED	9/15/08
QTY		2	
PER GAME		PER GAME	
FILENAME	PET000X REV 2.VSD		
DRAWN BY	NBRANCATO		
PAGE	11 OF 34		

4 3 2 1

4 3 2 1

D C B A

TO:  
MAIN I/O  
#PE2034X

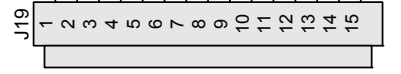

12"

TO:  
POWER SUPPLY  
PCB #DA2001X

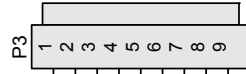

9 PIN PLUG #E02292  
PINS 1, 2, 4, 8 #E02100  
PINS 5, 6, 7, 9 #E02422

TITLE	PE2060LX	
DESCRIPTION	MAIN DC POWER HARNESS	FILENAME PE1000X REV 2.VSD
DATE	3/19/08	DRAWN BY NBRANCATO
	REVISED	PAGE
	9/15/08	12 OF 34

4 3 2 1

1 2 3 4

D C B A

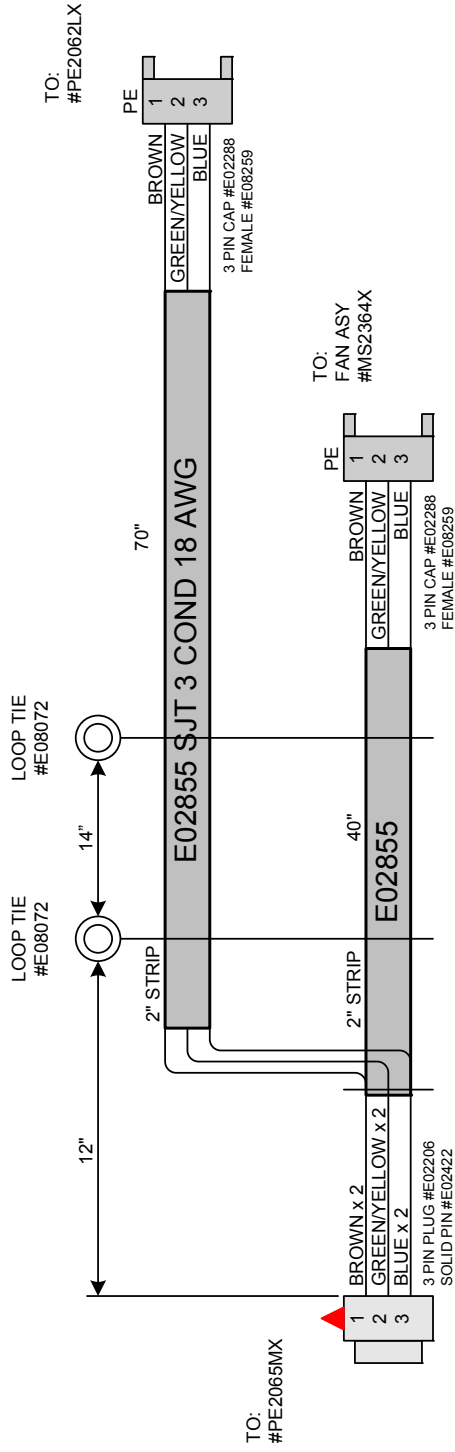

TITLE		PE2061MX	
DESCRIPTION	FILENAME	PE1000X REV 3 PRODUCTION.VSD	
	DRAWN BY	NBRANCATO	
DATE	REVISED	PAGE	17 OF 26
3/19/08	9/18/08	1	1

1 2 3 4

1 2 3 4

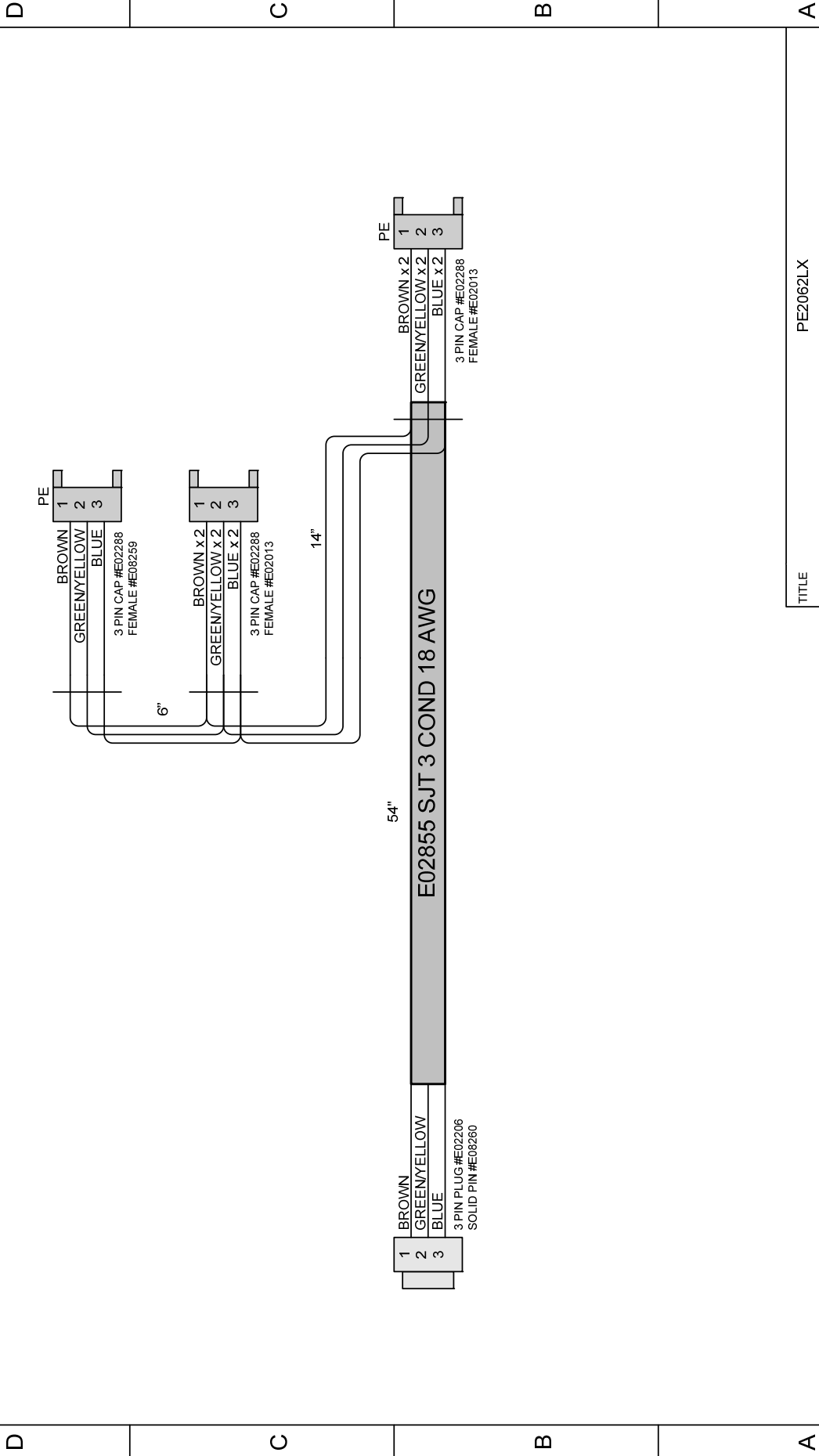

TITLE		PE2062LX	
DESCRIPTION	AC LIGHT HARNESS	FILENAME	PE1000X REV 2.VSD
DATE	3/19/08	DRAWN BY	NBRANCATO
REVISED	9/15/08	PAGE	14 OF 34

ALL WIRE IS 600V

1 2 3 4

4 3 2 1

D C B A

TO:  
TRANSFORMER  
#SX2002AX

LOOP TIE  
#E08072

TO:  
HALOGEN SOCKET  
#PE8520X

TO:  
HALOGEN SOCKET  
#PE8520X

TO:  
HALOGEN SOCKET  
#PE8520X

TO:  
HALOGEN SOCKET  
#PE8520X

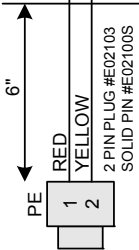

TITLE		PE2064MX	
DESCRIPTION	HALOGEN LIGHTS HARNESS	FILENAME	PE1000X REV
DATE	3/19/08	DRAWN BY	2.VSD
REVISED	9/15/08	PAGE	NBRANCATO
			16 OF 34

4 3 2 1

1 2 3 4

D C B A

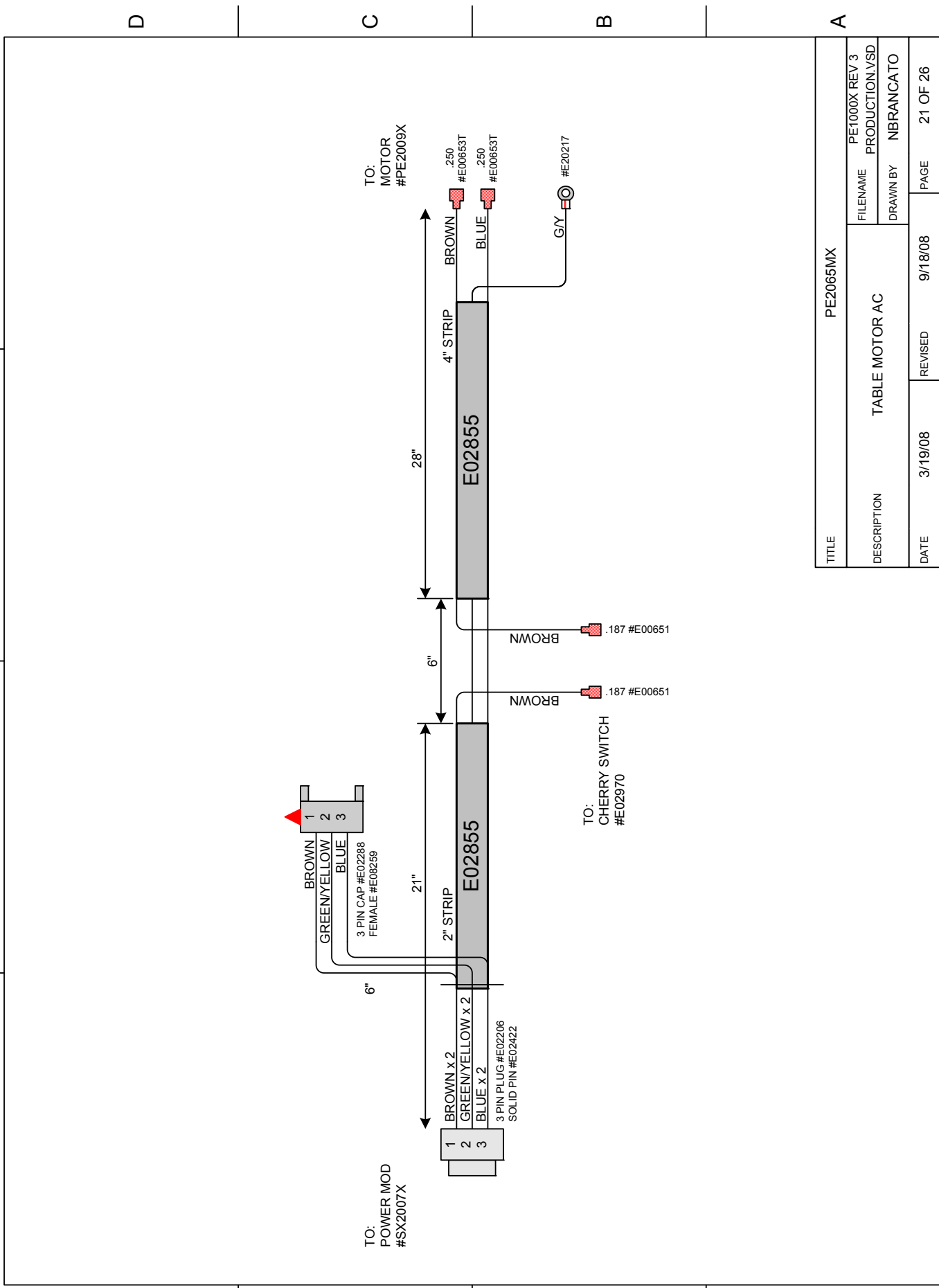

TITLE	PE2065MX		
DESCRIPTION	FILENAME	PE1000X REV 3 PRODUCTION.VSD	
	DRAWN BY	NBRANCATO	
DATE	3/19/08	REVISED	9/18/08
		PAGE	21 OF 26

1 2 3 4

4 3 2 1

D C B A

TO:  
MAIN I/O  
#PE2034X

TO:  
OTPO SWITCH PCB  
#PE2035X

1/2

J34 / J43

1	orange
2	green
3	white
4	black

4 PIN PLUG #E02089  
SOLID PIN #E02100S

90"

J1

1	orange
2	green
3	white
4	black
5	black

5 PIN AMP HOUSING #E02419  
CONTACT PIN #E02201

QTY		2		PER GAME	
TITLE PE20801X					
DESCRIPTION		OPTO SWITCH HARNESS		FILENAME	PE1000X REV
DATE		3/19/08		DRAWN BY	NBRANCATO
REVISED		9/15/08		PAGE	17 OF 34

4 3 2 1

4 3 2 1

D C B A

TO:  
MAIN I/O  
#PE2034X

TO:  
LED DISPLAY PCB  
#PE2036X

J33 / J42

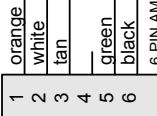

96"

J1

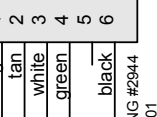

6 PIN AMP HOUSING #2944  
CONTACT PIN #2201

6 PIN AMP HOUSING #2944  
CONTACT PIN #2201

1 / 2

TITLE		QTY	2	PER GAME
PE2081LX				
DESCRIPTION		DISPLAY HARNESS		
DATE	3/19/08	REVISED	9/15/08	PAGE 18 OF 34
FILENAME		PE1000X REV 2.VSD		
DRAWN BY		NBRANCATO		

4 3 2 1

4 3 2 1

D C B A

TO:  
MAIN I/O  
#PE2034X

PE

J7

- 1 gray/green
- 2 gray/blue
- 3 gray/violet
- 4 gray
- 5
- 6
- 7
- 8
- 9 orange

9 PIN AMP HOUSING #8136  
CONTACT PIN #2201

78"

- 1 orange
- 2 gray/green
- 3 gray/blue
- 4 gray/violet
- 5 gray
- 6

6 PIN CAP #E02366  
FEMALE PIN #E02102

TO:  
#PE2082LX

TITLE		PE2082ELX	
DESCRIPTION		MARQUEE LED EXTENSION	
DATE	3/19/08	REVISED	9/15/08
FILENAME		PE1000X REV 2.VSD	
DRAWN BY		NBRANCATO	
PAGE		19 OF 34	

4 3 2 1

1 2 3 4

D C B A

TO:  
#PE2082ELX

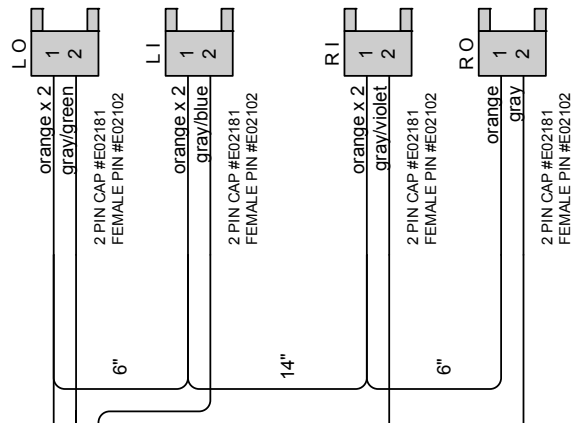
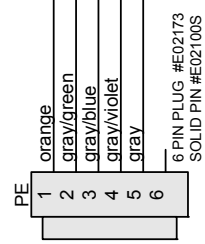

TO:  
LED STRIP  
#E00413PEX

TO:  
LED STRIP  
#E00412PEX

TO:  
LED STRIP  
#E00412PEX

TO:  
LED STRIP  
#E00413PEX

TITLE	PE2082LX	
DESCRIPTION	MARQUEE LED HARNESS	FILENAME PE1000X REV 2.VSD
DATE	3/19/08	DRAWN BY NBRANCATO
REVISED	9/15/08	PAGE 20 OF 34

1 2 3 4

1 2 3 4

D

C

B

A

TO: PW  
 MAIN I/O #PE2034X

J37 / J36

1	ORANGE
2	red
3	yellow/black
4	yellow/blue
5	yellow
6	yellow/red
7	black/red
8	black/yellow
9	black/green
10	black
11	white/orange
12	black

12 PIN AMP HOUSING #8428  
 CONTACT PIN #201

82"

6"

TO: #PE2083MX

1 / 2
1
2
3
4
5
6
7
8
9
10
11
12

ORANGE & orange  
 orange  
 yellow/black  
 yellow/blue  
 yellow/red  
 yellow  
 black/red  
 black/yellow  
 black/green  
 red  
 white/orange  
 black  
 12 PIN CAP #E02105  
 FEMALE PIN #E02102

D

C

B

A

1 2 3 4

TITLE		PE2083ELX		QTY	2	PER GAME
DESCRIPTION		BONUS WHEEL EXTENSION		FILENAME	PET000X REV 2.VSD	
DATE		3/19/08		DRAWN BY	NBRANCATO	
REVISED		9/15/08		PAGE	21 OF 34	

4 3 2 1

TO:  
WHEEL ASSEMBLY  
#PE2008X

TO:  
WHEEL ASSEMBLY  
#PE2008X

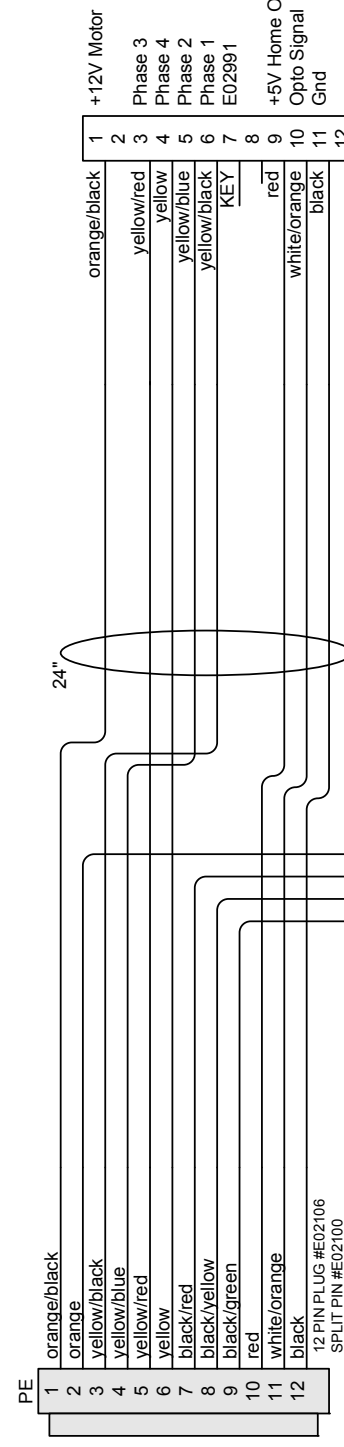

15 PIN CST-100 #E00385  
CONTACT PIN #E00383

Wheel assembly document shows inverted pin numbers

12 PIN PLUG #E02106  
SPLIT PIN #E02100

orange x 2  
black/red  
2 PIN RECP MINI MOLEX #E08537  
FEMALE PIN #E08536

orange x 2  
black/yellow  
2 PIN RECP MINI MOLEX #E08537  
FEMALE PIN #E08536

orange  
black/green  
2 PIN RECP MINI MOLEX #E08537  
FEMALE PIN #E08536

CUT TABS OFF OF CONNECTOR

CUT TABS OFF OF CONNECTOR

CUT TABS OFF OF CONNECTOR

TO:  
LED ASSEMBLY  
#8992FBX

D

C

B

A

D

C

B

A

TITLE		PE2083MX	
DESCRIPTION	BONUS WHEEL HARNESS	FILENAME	PE1000X REV 2.VSD
DATE	3/19/08	DRAWN BY	NBRANCATO
REVISED	9/15/08	PAGE	22 OF 34

4 3 2 1

4 3 2 1

D D

C C

B B

A A

TO:  
MAIN I/O  
#PE2034X

TO:  
LED #PE2084MX

PE  
1 / 2

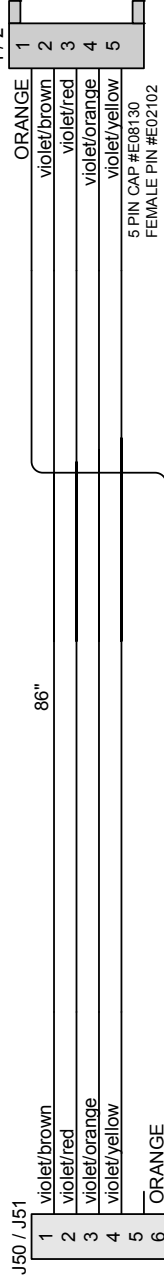

QTY 2		PER GAME
TITLE PE2084ELX		
DESCRIPTION BONUS LED EXTENSION	FILENAME	PE1000X REV
	DRAWN BY	2.VSD NBRANCATO
DATE	REVISED	PAGE
3/19/08	9/15/08	23 OF 34

4 3 2 1

4 3 2 1

TO:  
LED EXTENSION  
#PE2084ELX

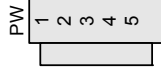

5 PIN PLUG #E08129  
SOLID PIN #E02100S

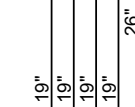

2 PIN CAP #E02181  
FEMALE PIN #E02102  
PIN 1 FEMALE #E08259

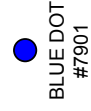

TO:  
LED #E00414PEX

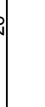

2 PIN CAP #E02181  
FEMALE PIN #E02102

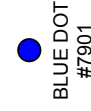

TO:  
LED #E00414PEX



2 PIN CAP #E02181  
FEMALE PIN #E02102



TO:  
LED #E00411PEX



2 PIN CAP #E02181  
FEMALE PIN #E02102

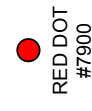

TO:  
LED #E00411PEX

13"



2 PIN CAP #E02181  
FEMALE PIN #E02102

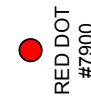

TO:  
LED #E00411PEX



2 PIN CAP #E02181  
FEMALE PIN #E02102

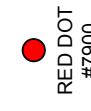

TO:  
LED #E00411PEX

QTY 2 PER GAME

TITLE		PE2084MX	
DESCRIPTION		FILENAME	PE1000X REV
DATE		DRAWN BY	2_VSD
3/19/08	REVISED	NBRANCATO	
		PAGE	24 OF 34

4 3 2 1

1  
2  
3  
4

D C B A

TO:  
MAIN I/O  
#PE2034X

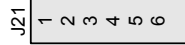

50"

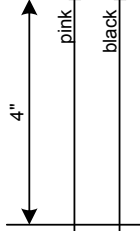

TO:  
TILT SENSOR  
#CP1051

6 PIN CST-100 #E08634  
CONTACT PIN #E00383

TITLE	PE2085LX	
DESCRIPTION	TILT SENSOR HARNESS	FILENAME PE1000X REV 2.VSD
DATE	3/19/08	DRAWN BY NBRANCATO
	REVISED	PAGE 25 OF 34
	9/15/08	1

1  
2  
3  
4

1 2 3 4

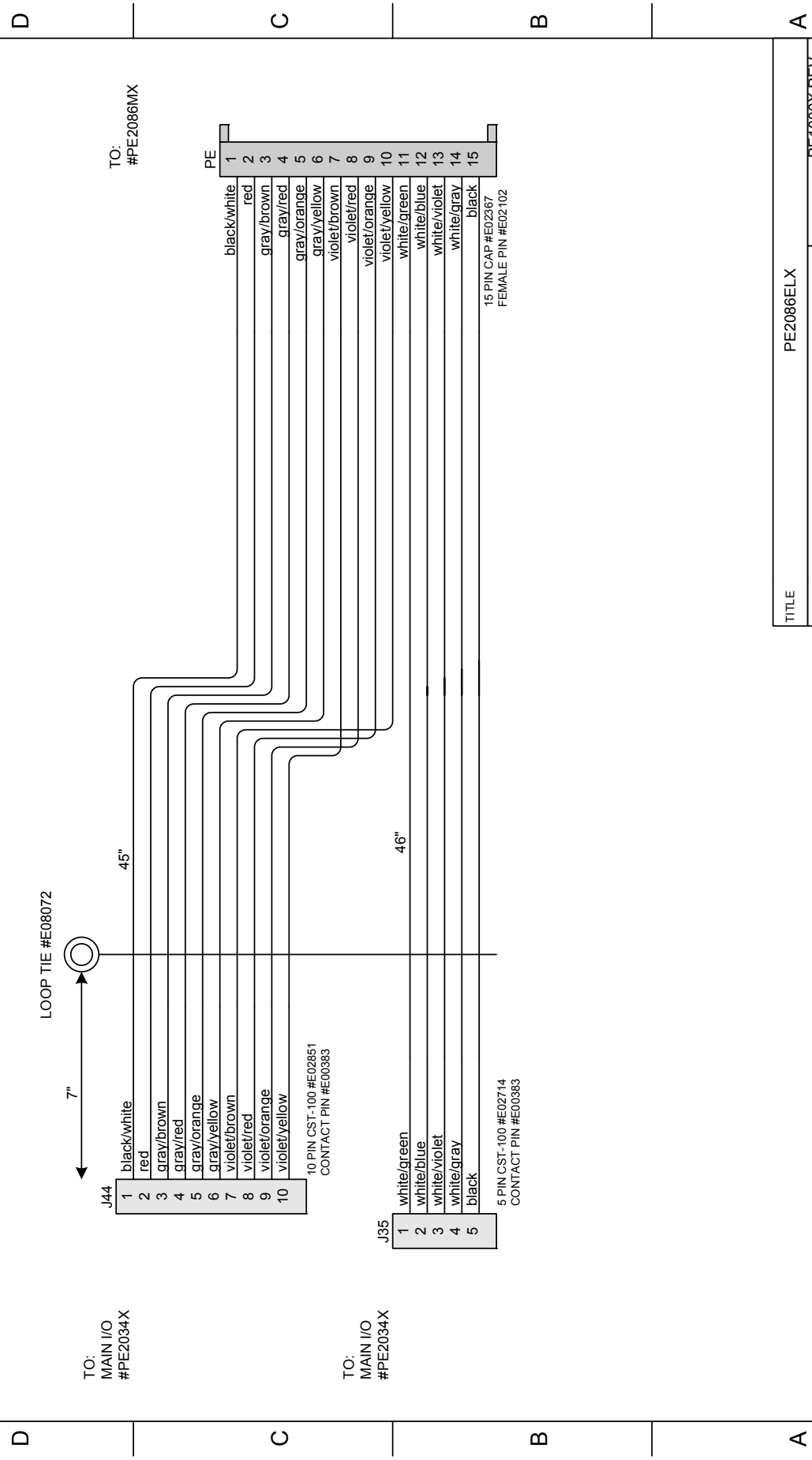

TITLE		PE2086ELX	
DESCRIPTION	PROGRAMMING EXTENSION	FILENAME	PE1000X REV 2.VSD
DATE	3/19/08	DRAWN BY	NBRANCATO
	REVISED	9/15/08	PAGE 26 OF 34

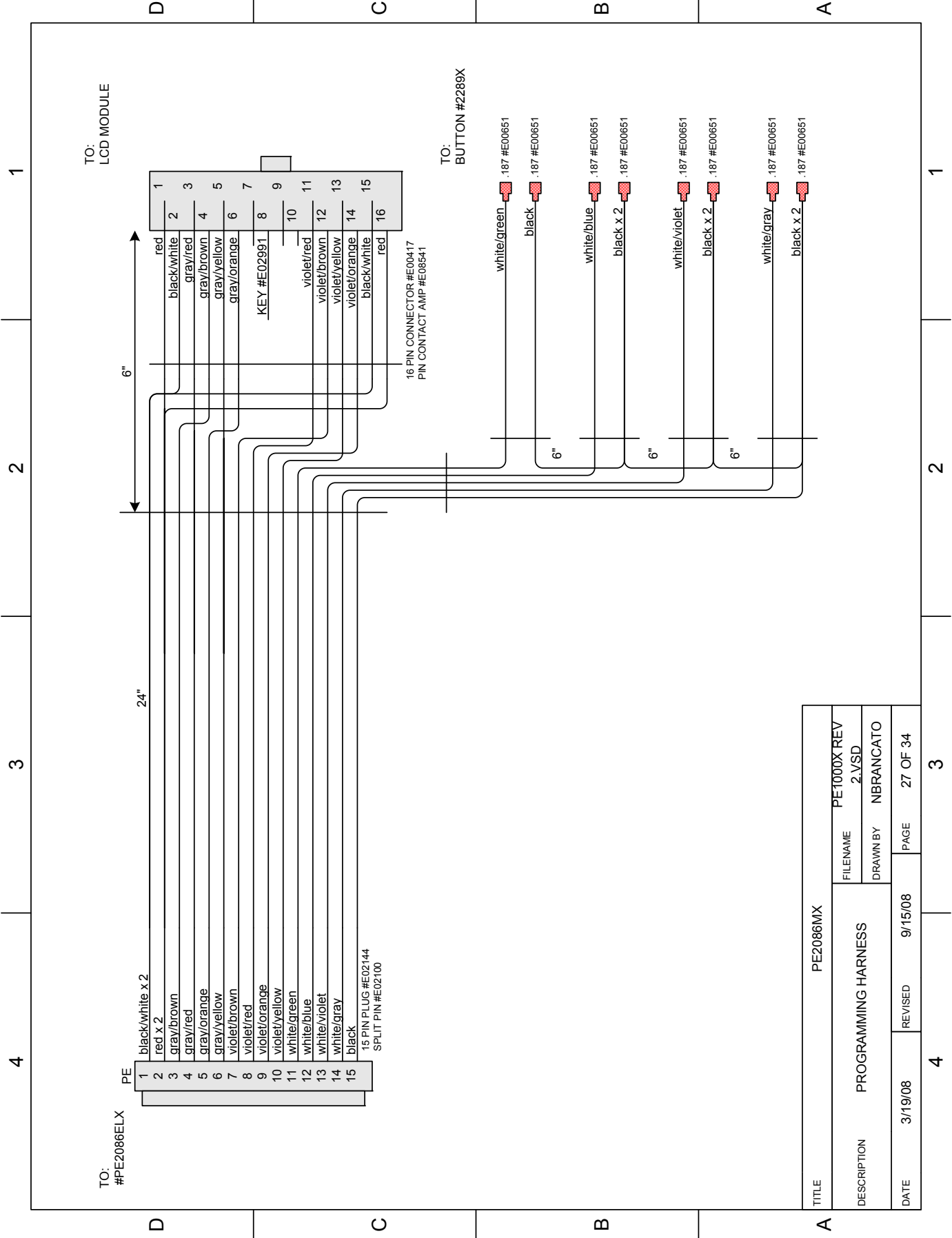

TO:  
LCD MODULE

TO:  
#PE2086ELX

TO:  
BUTTON #2289X

1	red
2	black/white
3	gray/red
4	gray/brown
5	gray/yellow
6	gray/orange
7	violet/red
8	violet/orange
9	violet/yellow
10	violet/brown
11	violet/gray
12	white/violet
13	white/gray
14	black
15	black

1	black/white x 2
2	red x 2
3	gray/brown
4	gray/red
5	gray/orange
6	gray/yellow
7	violet/brown
8	violet/red
9	violet/orange
10	violet/yellow
11	white/green
12	white/blue
13	white/violet
14	white/gray
15	black

16 PIN CONNECTOR #E00417  
PIN CONTACT AMP #E08541

15 PIN PLUG #E02144  
SPLIT PIN #E02100

TITLE		PE2086MX	
DESCRIPTION		PROGRAMMING HARNESS	FILENAME PE1000X REV 2.VSD
DATE	3/19/08	REVISED	9/15/08
PAGE		27 OF 34	

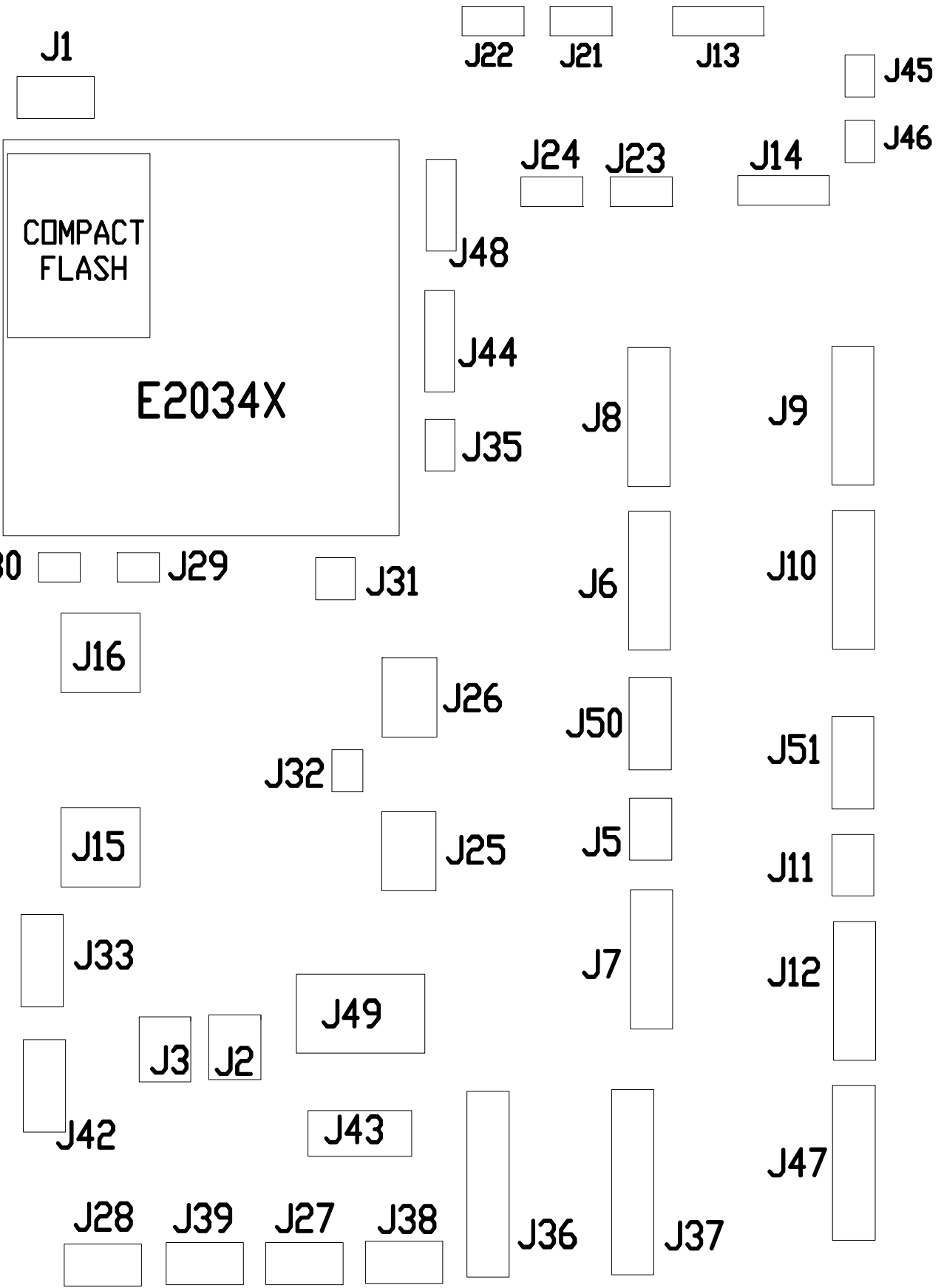

# WARRANTY

I.C.E warrants all components in the **Plinko™** game to be free of defects in materials and workmanship for a period listed on the next page from the date of purchase.

This warranty does not cover items damaged due to normal wear and tear, subjected to abuse, improperly assembled by the end user, modified, repaired, or operated in a fashion other than that described in the service manual.

If your **Plinko™** game fails to conform to the above-mentioned warranty, I.C.E.'s sole responsibility shall be at its option to repair or replace any defective component with a new or remanufactured component of equal to or greater O.E.M. specification.

I.C.E. will assume no liability whatsoever, for costs associated with labor to replace defective parts, or travel time associated therein.

I.C.E.'s obligation will be to ship free of charge, replacement parts by domestic U.P.S. Ground, U.S. mail, or other comparable shipping means. Any express mail or overnight shipping expense is at the cost of the purchaser.

Products will be covered under warranty only when:

- The serial number of the game with the defective parts is given. A tech number has been issued by an I.C.E. technical representative.
- The serial number of the defective part, if applicable, is given.
- Defective parts are returned to I.C.E., shipping pre-paid, in a timely fashion, if requested by I.C.E.
- A copy of the sales receipt is available as proof of purchase upon request of I.C.E.

I.C.E. distributors are independent, privately owned and operated. In their judgment, they may sell parts or accessories other than those manufactured by I.C.E. We cannot be responsible for the quality, suitability, or safety of any non-I.C.E. part, or any modification, including labor, which is performed by such a distributor.



# WARRANTY

When placing a warranty request, please be prepared to provide the following information:

- Serial Number of Game or Bill of Sale
- Machine Type
- A Detailed Description of the Equipment Fault Symptoms

Plinko is warranted as follows:

- 1 year on the Main PCB assembly
- 1 year on the Pusher Deck Motor
- 1 year on the power supply assemblies
- 6 months on all other components (i.e. DBV's, Ticket Dispensers, sensors, etc)

ICE Inc shall not be obligated to furnish a warranty request under the following conditions:

- Equipment has been subjected to unwarranted stress through abuse or neglect
- Equipment has been damaged as a result of arbitrary repair/modification attempts
- Equipment that has failed through normal wear and tear

ICE Inc will assume no liability whatsoever for costs associated with labor to replace defective parts or travel time associated therein.

All defective warranty covered components will be replaced with new or factory refurbished components equal to OEM specifications. ICE Inc will cover all domestic UPS ground, or comparable shipping means, freight costs during the warranty period. Expedited shipments are available for an additional charge.

Defective parts are returned to ICE Inc, at the customer's expense, in a timely fashion.

ICE distributors are independent, privately owned and operated. In their judgment, they may sell parts and/or accessories other than those manufactured by ICE Inc. We cannot be responsible for the quality, suitability or safety of any non-ICE part, modification (including labor) that is performed by such a distributor.

I.C.E. Parts/Service Dept.  
Innovative Concepts in Entertainment  
10123 Main St.  
Clarence, NY 14031  
Phone #: (716) - 759 - 0360  
Fax #: (716) - 759 - 0884